

**ORDINANCE NO. 10397 (NEW SERIES)**

**AN ORDINANCE CHANGING THE ZONING CLASSIFICATION OF CERTAIN PROPERTY  
WITHIN THE COUNTY OF SAN DIEGO RELATED TO THE 2015 GENERAL PLAN CLEAN-  
UP GENERAL PLAN AMENDMENT AND REZONE – ITEM SD201  
(GPA 14-001; REZ 14-001)**

The Board of Supervisors of the County of San Diego ordains as follows:

**SAN DIEGUITO**

**Section 1.** The zoning classification of certain real property is hereby changed as set forth herein, and more precisely delineated on the San Dieguito Zoning Use Regulation Changes Map identified as Map SD-UR-201 from the November 18, 2015 Board of Supervisors Meeting, all documents on file with the Clerk of the Board of Supervisors of the County of San Diego.

Use Regulation Changes

<b>Sub-Area No.</b>	<b>Old</b>	<b>New</b>
SD-UR-201	N/A	RV

**Section 2.** The zoning classification of certain real property is hereby changed as set forth herein, and more precisely delineated on the San Dieguito Density Changes Map identified as Map SD-DN-201 from the November 18, 2015 Board of Supervisors Meeting, all documents on file with the Clerk of the Board of Supervisors of the County of San Diego.

Density Changes

<b>Sub-Area No.</b>	<b>Old</b>	<b>New</b>
SD-DN-201	N/A	-

**Section 3.** The zoning classification of certain real property is hereby changed as set forth herein, and more precisely delineated on the San Dieguito Zoning Minimum Lot Size Changes Map identified as Map SD-LS-201 from the November 18, 2015 Board of Supervisors Meeting, all documents on file with the Clerk of the Board of Supervisors of the County of San Diego.

Minimum Lot Size Changes

<b>Sub-Area No.</b>	<b>Old</b>	<b>New</b>
SD-LS-201	N/A	-

**Section 4.** The zoning classification of certain real property is hereby changed as set forth herein, and more precisely delineated on the San Dieguito Zoning Animal Regulation Changes Map identified as Map SD-AR-201 from the November 18, 2015 Board of Supervisors Meeting, all documents on file with the Clerk of the Board of Supervisors of the County of San Diego.

Animal Regulation Changes

<b>Sub-Area No.</b>	<b>Old</b>	<b>New</b>
JLSD-AR-201	N/A	A

**Section 5.** The zoning classification of certain real property is hereby changed as set forth herein, and more precisely delineated on the San Dieguito Building Type Changes Map identified as Map SD-BT-201 from the November 18, 2015 Board of Supervisors Meeting, all documents on file with the Clerk of the Board of Supervisors of the County of San Diego.

#### Building Type Changes

<b>Sub-Area No.</b>	<b>Old</b>	<b>New</b>
SD-BT-201	N/A	L

**Section 6.** The zoning classification of certain real property is hereby changed as set forth herein, and more precisely delineated on the San Dieguito Maximum Floor Area Changes Map identified as Map SD-MFA-201 from the November 18, 2015 Board of Supervisors Meeting, all documents on file with the Clerk of the Board of Supervisors of the County of San Diego.

#### Maximum Floor Area Changes

<b>Sub-Area No.</b>	<b>Old</b>	<b>New</b>
SD-MFA-201	N/A	-

**Section 7.** The zoning classification of certain real property is hereby changed as set forth herein, and more precisely delineated on the San Dieguito Floor Area Ratio Changes Map identified as Map SD-FAR-201 from the November 18, 2015 Board of Supervisors Meeting, all documents on file with the Clerk of the Board of Supervisors of the County of San Diego.

#### Floor Area Ratio Changes

<b>Sub-Area No.</b>	<b>Old</b>	<b>New</b>
SD-FAR-201	N/A	-

**Section 8.** The zoning classification of certain real property is hereby changed as set forth herein, and more precisely delineated on the San Dieguito Height Changes Map identified as Map SD-HT-201 from the November 18, 2015 Board of Supervisors Meeting, all documents on file with the Clerk of the Board of Supervisors of the County of San Diego.

#### Height Changes

<b>Sub-Area No.</b>	<b>Old</b>	<b>New</b>
SD-HT-201	N/A	G

**Section 9.** The zoning classification of certain real property is hereby changed as set forth herein, and more precisely delineated on the San Dieguito Lot Coverage Changes Map identified as Map SD-LC-201 from the November 18, 2015 Board of Supervisors Meeting, all documents on file with the Clerk of the Board of Supervisors of the County of San Diego.

Meeting Date: 11/18/15 (3)

#### Lot Coverage Changes

Sub-Area No.	Old	New
SD-LC-201	N/A	0.6

**Section 10.** The zoning classification of certain real property is hereby changed as set forth herein, and more precisely delineated on the San Dieguito Setback Changes Map identified as Map SD-SB-201 from the November 18, 2015 Board of Supervisors Meeting, all documents on file with the Clerk of the Board of Supervisors of the County of San Diego.

#### Setback Changes

Sub-Area No.	Old	New
SD-SB-201	N/A	V

**Section 11.** The zoning classification of certain real property is hereby changed as set forth herein, and more precisely delineated on the San Dieguito Open Space Regulation Changes Map identified as Map SD-OS-201 from the November 18, 2015 Board of Supervisors Meeting, all documents on file with the Clerk of the Board of Supervisors of the County of San Diego.

#### Open Space Changes

Sub-Area No.	Old	New
SD-OS-201	N/A	B

**Section 12.** The zoning classification of certain real property is hereby changed as set forth herein, and more precisely delineated on the San Dieguito Special Regulation Changes Map identified as Map SD-SR-201 from the June November 18, 2015 of Supervisors Meeting, all documents on file with the Clerk of the Board of Supervisors of the County of San Diego.

#### Special Regulation Changes

Sub-Area No.	Old	New
SD-SR-201	N/A	P,R

**Section 13. Effective Date.** This Ordinance shall take effect and be in force 30 days after approval. Before the expiration of 15 days after its passage, a summary shall be published once with the names of the members voting for and against the same in the Daily Transcript, a newspaper of general circulation published in the County of San Diego.

**Section 14. Operative Date.** This Ordinance shall not be operative until the area (Item SD201) identified in each of the attached maps has been detached from the City of Encinitas by the San Diego Local Agency Formation Commission (LAFCO). If the detachment is denied, the zone classifications set forth in this Ordinance shall not take effect.

PASSED, APPROVED, AND ADOPTED by the Board of Supervisors of the County of San Diego this 18<sup>th</sup> day of November, 2015.

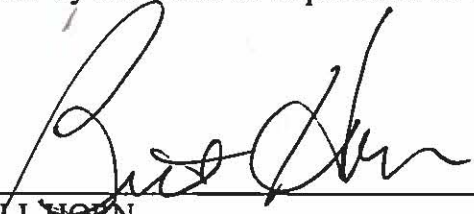
  
\_\_\_\_\_  
BILL HORN  
Chairman, Board of Supervisors  
County of San Diego, State of California

The above Ordinance was adopted by the following vote:

AYES: Cox, Jacob, D. Roberts, R. Roberts, Horn

ATTEST my hand and the seal of the Board of Supervisors this 18<sup>th</sup> day of November, 2015.

DAVID HALL  
Clerk of the Board of Supervisors

By   
\_\_\_\_\_  
Elizabeth Miller, Deputy





Ordinance No. 10397 (N.S.)

11/18/15 (3)

COUNTY OF SAN DIEGO  
San Diego

Legend

-  Proposed Annual Regulations (Area of Change)
-  Existing Use Regulation (No Change)
-  Planning Boundary
-  Assessor Parcel
-  Lanes
-  Road

Parcel Number(s)  
200713700

Annual Use Regulations  
Repealed (PA, AR, MR, OR, PR, SR, TR, UR, VR, WR, XZ)  
Amended (PA, AR, MR, OR, PR, SR, TR, UR, VR, WR, XZ) (A, B, C, D, E, F, G, H, I, J, K, L, M, N, O, P, Q, R, S, T, U, V, W, X, Y, Z)  
Repealed (PA, AR, MR, OR, PR, SR, TR, UR, VR, WR, XZ) (A, B, C, D, E, F, G, H, I, J, K, L, M, N, O, P, Q, R, S, T, U, V, W, X, Y, Z)  
Special Purpose (AR, MR, OR, PR, SR, TR, UR, VR, WR, XZ) (A, B, C, D, E, F, G, H, I, J, K, L, M, N, O, P, Q, R, S, T, U, V, W, X, Y, Z)

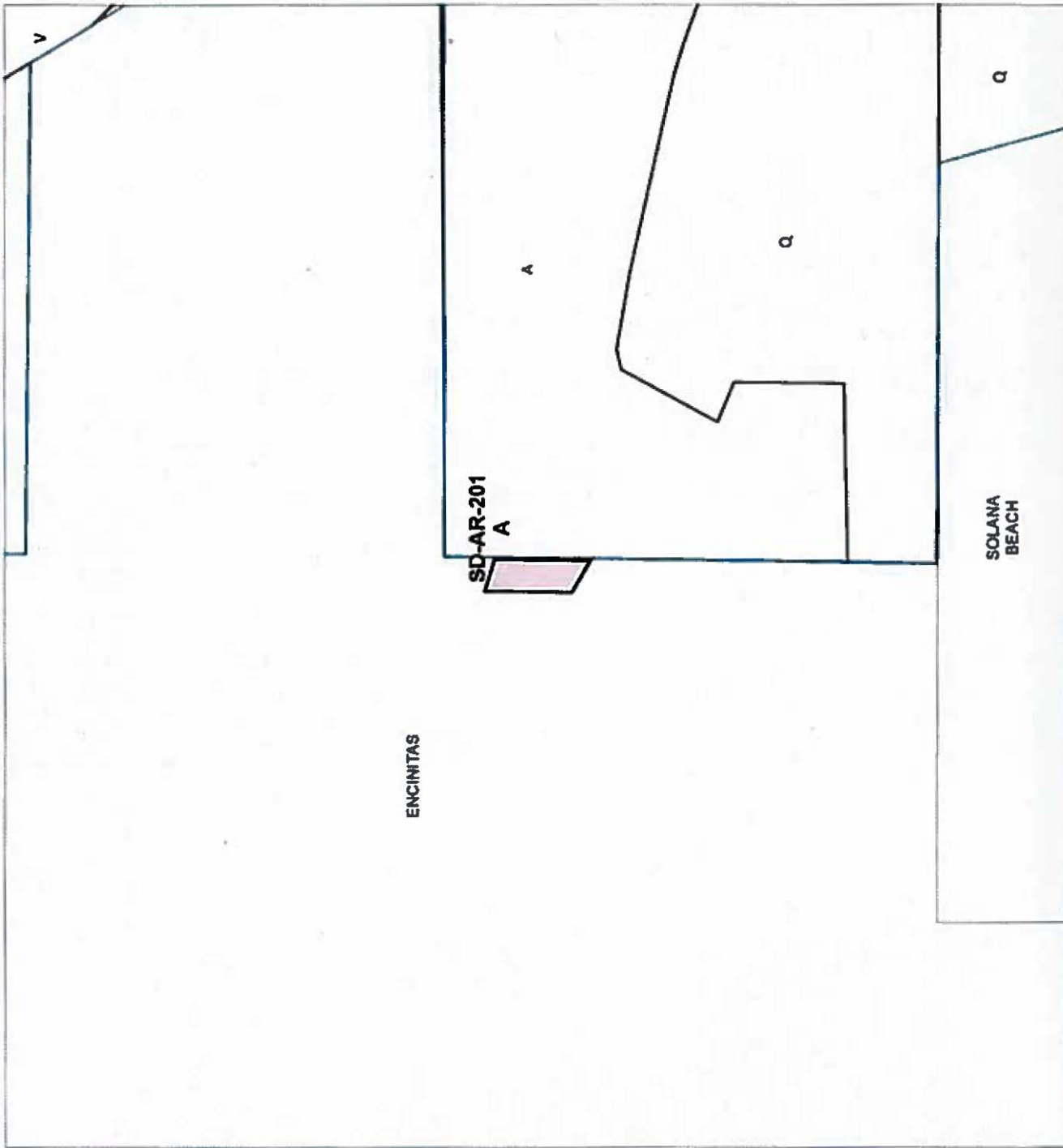
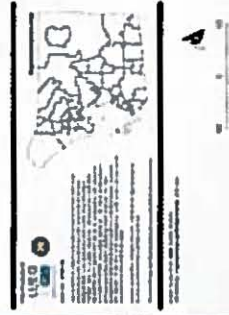





COUNTY OF SAN DIEGO  
*San Diego*

- Legend
- Proposed Density Regulations (Areas of Change)
  - Existing Use Regulation (No Change)
  - Planning Boundary
  - Address Parcel
  - Labels
  - Walls

Parcel Number(s)  
202813700

zoning map amendments  
Board Resolution No. 104, 105, 106, 107, 108, 109, 110, 111, 112, 113, 114, 115, 116, 117, 118, 119, 120, 121, 122, 123, 124, 125, 126, 127, 128, 129, 130, 131, 132, 133, 134, 135, 136, 137, 138, 139, 140, 141, 142, 143, 144, 145, 146, 147, 148, 149, 150, 151, 152, 153, 154, 155, 156, 157, 158, 159, 160, 161, 162, 163, 164, 165, 166, 167, 168, 169, 170, 171, 172, 173, 174, 175, 176, 177, 178, 179, 180, 181, 182, 183, 184, 185, 186, 187, 188, 189, 190, 191, 192, 193, 194, 195, 196, 197, 198, 199, 200, 201, 202, 203, 204, 205, 206, 207, 208, 209, 210, 211, 212, 213, 214, 215, 216, 217, 218, 219, 220, 221, 222, 223, 224, 225, 226, 227, 228, 229, 230, 231, 232, 233, 234, 235, 236, 237, 238, 239, 240, 241, 242, 243, 244, 245, 246, 247, 248, 249, 250, 251, 252, 253, 254, 255, 256, 257, 258, 259, 260, 261, 262, 263, 264, 265, 266, 267, 268, 269, 270, 271, 272, 273, 274, 275, 276, 277, 278, 279, 280, 281, 282, 283, 284, 285, 286, 287, 288, 289, 290, 291, 292, 293, 294, 295, 296, 297, 298, 299, 300, 301, 302, 303, 304, 305, 306, 307, 308, 309, 310, 311, 312, 313, 314, 315, 316, 317, 318, 319, 320, 321, 322, 323, 324, 325, 326, 327, 328, 329, 330, 331, 332, 333, 334, 335, 336, 337, 338, 339, 340, 341, 342, 343, 344, 345, 346, 347, 348, 349, 350, 351, 352, 353, 354, 355, 356, 357, 358, 359, 360, 361, 362, 363, 364, 365, 366, 367, 368, 369, 370, 371, 372, 373, 374, 375, 376, 377, 378, 379, 380, 381, 382, 383, 384, 385, 386, 387, 388, 389, 390, 391, 392, 393, 394, 395, 396, 397, 398, 399, 400, 401, 402, 403, 404, 405, 406, 407, 408, 409, 410, 411, 412, 413, 414, 415, 416, 417, 418, 419, 420, 421, 422, 423, 424, 425, 426, 427, 428, 429, 430, 431, 432, 433, 434, 435, 436, 437, 438, 439, 440, 441, 442, 443, 444, 445, 446, 447, 448, 449, 450, 451, 452, 453, 454, 455, 456, 457, 458, 459, 460, 461, 462, 463, 464, 465, 466, 467, 468, 469, 470, 471, 472, 473, 474, 475, 476, 477, 478, 479, 480, 481, 482, 483, 484, 485, 486, 487, 488, 489, 490, 491, 492, 493, 494, 495, 496, 497, 498, 499, 500, 501, 502, 503, 504, 505, 506, 507, 508, 509, 510, 511, 512, 513, 514, 515, 516, 517, 518, 519, 520, 521, 522, 523, 524, 525, 526, 527, 528, 529, 530, 531, 532, 533, 534, 535, 536, 537, 538, 539, 540, 541, 542, 543, 544, 545, 546, 547, 548, 549, 550, 551, 552, 553, 554, 555, 556, 557, 558, 559, 560, 561, 562, 563, 564, 565, 566, 567, 568, 569, 570, 571, 572, 573, 574, 575, 576, 577, 578, 579, 580, 581, 582, 583, 584, 585, 586, 587, 588, 589, 590, 591, 592, 593, 594, 595, 596, 597, 598, 599, 600, 601, 602, 603, 604, 605, 606, 607, 608, 609, 610, 611, 612, 613, 614, 615, 616, 617, 618, 619, 620, 621, 622, 623, 624, 625, 626, 627, 628, 629, 630, 631, 632, 633, 634, 635, 636, 637, 638, 639, 640, 641, 642, 643, 644, 645, 646, 647, 648, 649, 650, 651, 652, 653, 654, 655, 656, 657, 658, 659, 660, 661, 662, 663, 664, 665, 666, 667, 668, 669, 670, 671, 672, 673, 674, 675, 676, 677, 678, 679, 680, 681, 682, 683, 684, 685, 686, 687, 688, 689, 690, 691, 692, 693, 694, 695, 696, 697, 698, 699, 700, 701, 702, 703, 704, 705, 706, 707, 708, 709, 710, 711, 712, 713, 714, 715, 716, 717, 718, 719, 720, 721, 722, 723, 724, 725, 726, 727, 728, 729, 730, 731, 732, 733, 734, 735, 736, 737, 738, 739, 740, 741, 742, 743, 744, 745, 746, 747, 748, 749, 750, 751, 752, 753, 754, 755, 756, 757, 758, 759, 760, 761, 762, 763, 764, 765, 766, 767, 768, 769, 770, 771, 772, 773, 774, 775, 776, 777, 778, 779, 780, 781, 782, 783, 784, 785, 786, 787, 788, 789, 790, 791, 792, 793, 794, 795, 796, 797, 798, 799, 800, 801, 802, 803, 804, 805, 806, 807, 808, 809, 810, 811, 812, 813, 814, 815, 816, 817, 818, 819, 820, 821, 822, 823, 824, 825, 826, 827, 828, 829, 830, 831, 832, 833, 834, 835, 836, 837, 838, 839, 840, 841, 842, 843, 844, 845, 846, 847, 848, 849, 850, 851, 852, 853, 854, 855, 856, 857, 858, 859, 860, 861, 862, 863, 864, 865, 866, 867, 868, 869, 870, 871, 872, 873, 874, 875, 876, 877, 878, 879, 880, 881, 882, 883, 884, 885, 886, 887, 888, 889, 890, 891, 892, 893, 894, 895, 896, 897, 898, 899, 900, 901, 902, 903, 904, 905, 906, 907, 908, 909, 910, 911, 912, 913, 914, 915, 916, 917, 918, 919, 920, 921, 922, 923, 924, 925, 926, 927, 928, 929, 930, 931, 932, 933, 934, 935, 936, 937, 938, 939, 940, 941, 942, 943, 944, 945, 946, 947, 948, 949, 950, 951, 952, 953, 954, 955, 956, 957, 958, 959, 960, 961, 962, 963, 964, 965, 966, 967, 968, 969, 970, 971, 972, 973, 974, 975, 976, 977, 978, 979, 980, 981, 982, 983, 984, 985, 986, 987, 988, 989, 990, 991, 992, 993, 994, 995, 996, 997, 998, 999, 1000

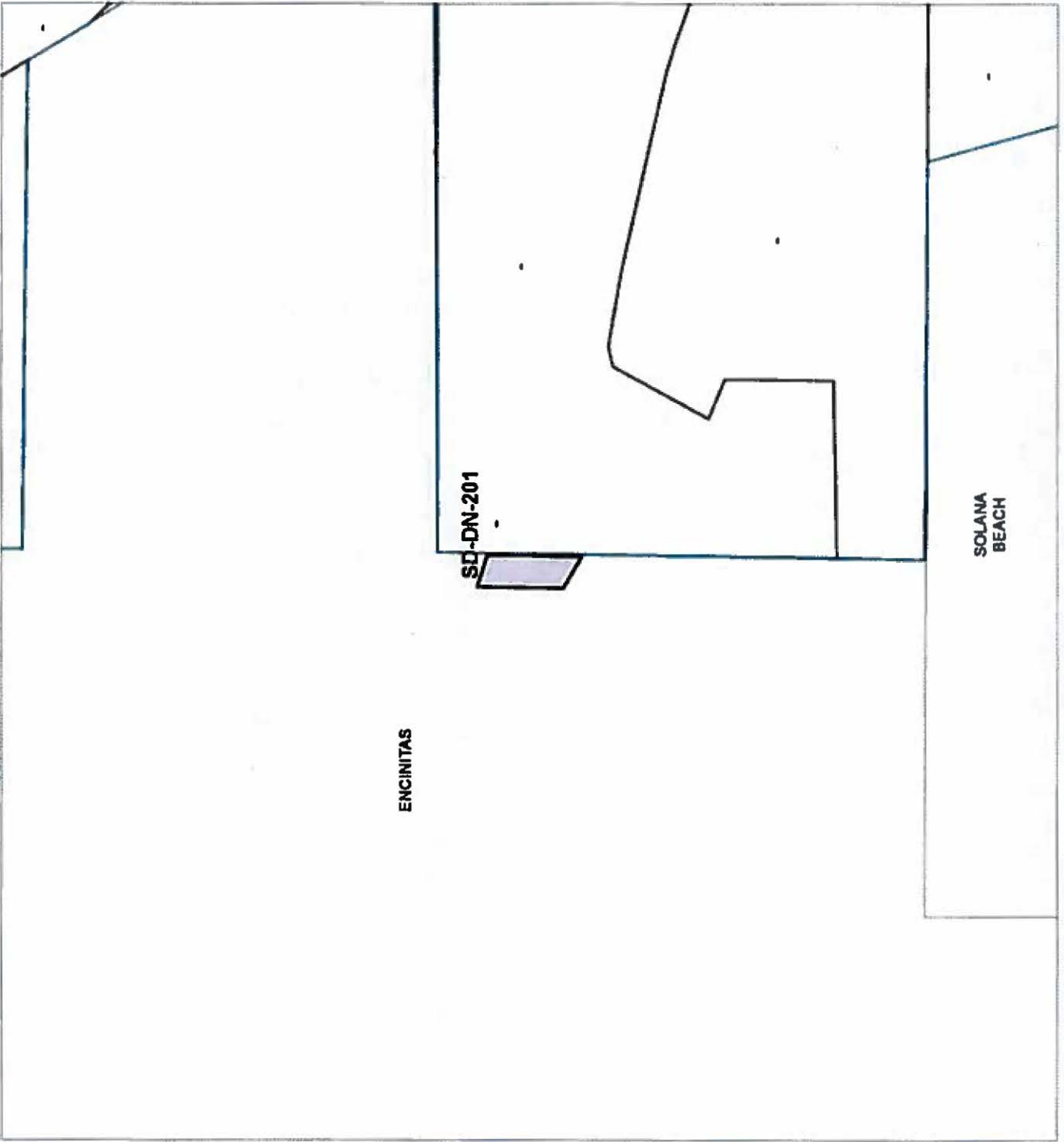

COUNTY OF SAN DIEGO  
*San Dieguito*

LEGEND

-  Proposed Five Year Rate Repletions (Areas of Change)
-  Existing Use Repletions (No Change)
-  Proposed Boundary
-  Assessor Parcels
-  Ranch

Period: March 2011  
2529712700

County Seal Implications:  
Proposed FY 2011-2015, FY 2016, FY 2017, FY 2018, FY 2019  
Commercial: 2011-2015: 1.00, 1.00, 1.00, 1.00, 1.00, 1.00, 1.00, 1.00, 1.00, 1.00  
Residential: 2011-2015: 1.00, 1.00, 1.00, 1.00, 1.00, 1.00, 1.00, 1.00, 1.00, 1.00  
Special Purpose: (Ind. All. 102, 106, 147, 160, 162, 164, 166, 168, 170, 172, 174, 176, 178, 180, 182, 184, 186, 188, 190, 192, 194, 196, 198, 200, 202, 204, 206, 208, 210, 212, 214, 216, 218, 220, 222, 224, 226, 228, 230, 232, 234, 236, 238, 240, 242, 244, 246, 248, 250, 252, 254, 256, 258, 260, 262, 264, 266, 268, 270, 272, 274, 276, 278, 280, 282, 284, 286, 288, 290, 292, 294, 296, 298, 300, 302, 304, 306, 308, 310, 312, 314, 316, 318, 320, 322, 324, 326, 328, 330, 332, 334, 336, 338, 340, 342, 344, 346, 348, 350, 352, 354, 356, 358, 360, 362, 364, 366, 368, 370, 372, 374, 376, 378, 380, 382, 384, 386, 388, 390, 392, 394, 396, 398, 400, 402, 404, 406, 408, 410, 412, 414, 416, 418, 420, 422, 424, 426, 428, 430, 432, 434, 436, 438, 440, 442, 444, 446, 448, 450, 452, 454, 456, 458, 460, 462, 464, 466, 468, 470, 472, 474, 476, 478, 480, 482, 484, 486, 488, 490, 492, 494, 496, 498, 500, 502, 504, 506, 508, 510, 512, 514, 516, 518, 520, 522, 524, 526, 528, 530, 532, 534, 536, 538, 540, 542, 544, 546, 548, 550, 552, 554, 556, 558, 560, 562, 564, 566, 568, 570, 572, 574, 576, 578, 580, 582, 584, 586, 588, 590, 592, 594, 596, 598, 600, 602, 604, 606, 608, 610, 612, 614, 616, 618, 620, 622, 624, 626, 628, 630, 632, 634, 636, 638, 640, 642, 644, 646, 648, 650, 652, 654, 656, 658, 660, 662, 664, 666, 668, 670, 672, 674, 676, 678, 680, 682, 684, 686, 688, 690, 692, 694, 696, 698, 700, 702, 704, 706, 708, 710, 712, 714, 716, 718, 720, 722, 724, 726, 728, 730, 732, 734, 736, 738, 740, 742, 744, 746, 748, 750, 752, 754, 756, 758, 760, 762, 764, 766, 768, 770, 772, 774, 776, 778, 780, 782, 784, 786, 788, 790, 792, 794, 796, 798, 800, 802, 804, 806, 808, 810, 812, 814, 816, 818, 820, 822, 824, 826, 828, 830, 832, 834, 836, 838, 840, 842, 844, 846, 848, 850, 852, 854, 856, 858, 860, 862, 864, 866, 868, 870, 872, 874, 876, 878, 880, 882, 884, 886, 888, 890, 892, 894, 896, 898, 900, 902, 904, 906, 908, 910, 912, 914, 916, 918, 920, 922, 924, 926, 928, 930, 932, 934, 936, 938, 940, 942, 944, 946, 948, 950, 952, 954, 956, 958, 960, 962, 964, 966, 968, 970, 972, 974, 976, 978, 980, 982, 984, 986, 988, 990, 992, 994, 996, 998, 1000)

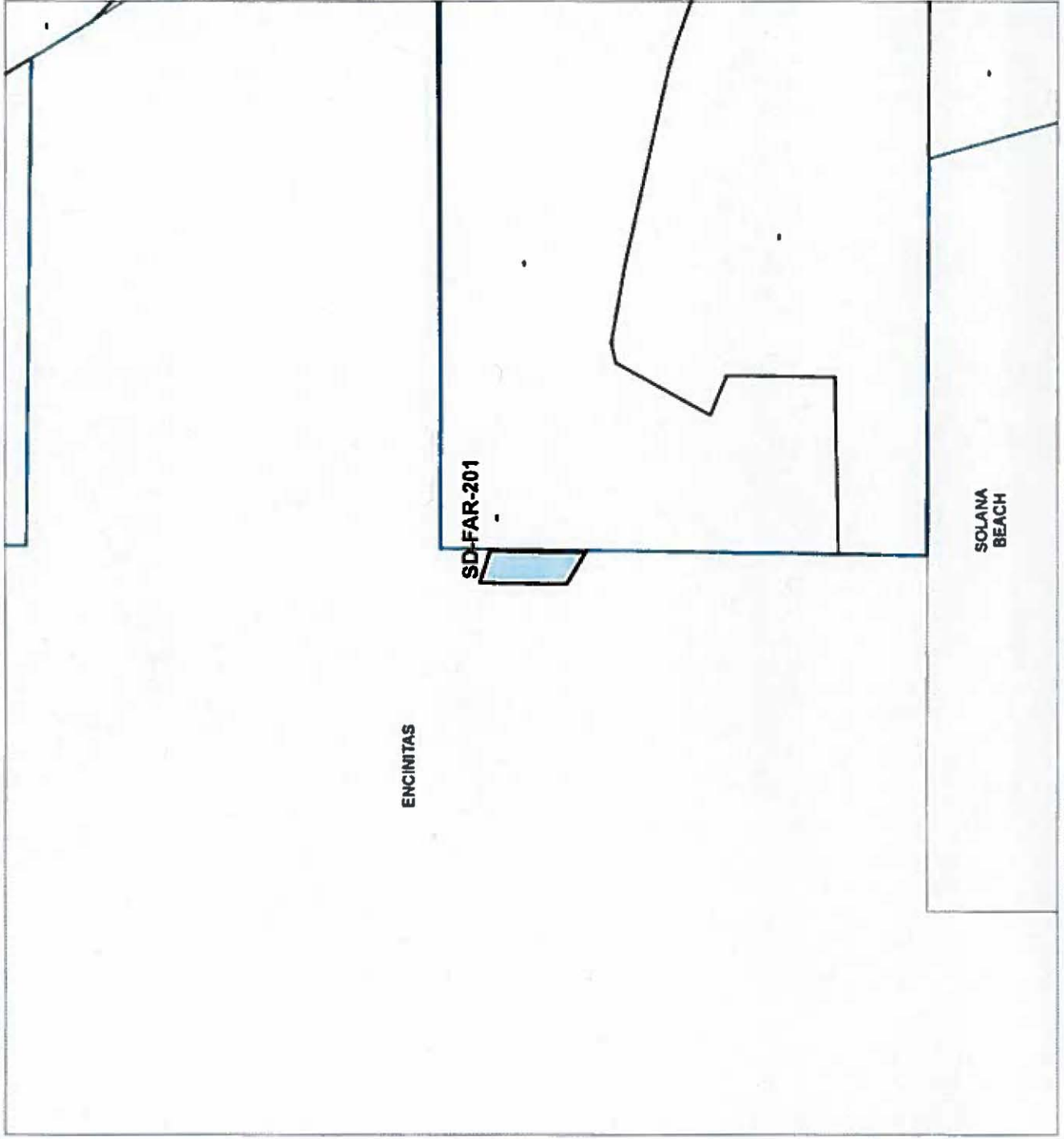

Scale: 0 100 200 Feet



San Diego County Assessor's Office  
2011-2015 Five Year Rate Repletions  
Map No. 2011-2015-001  
Date: 03/28/2011





COUNTY OF SAN DIEGO  
San Diego

Legend

-  Proposed Lot Coverage Regulations (Area of Change)
-  Existing Use Regulation (no Change)
-  Planning Boundary
-  Assessor's Parcels
-  Labels
-  Roads

Parcel Number(s)  
200113700

zoning map boundaries  
 Ordinance No. 164, 194, 196, 198, 199, 200, 201, 202, 203, 204, 205, 206, 207, 208, 209, 210, 211, 212, 213, 214, 215, 216, 217, 218, 219, 220, 221, 222, 223, 224, 225, 226, 227, 228, 229, 230, 231, 232, 233, 234, 235, 236, 237, 238, 239, 240, 241, 242, 243, 244, 245, 246, 247, 248, 249, 250, 251, 252, 253, 254, 255, 256, 257, 258, 259, 260, 261, 262, 263, 264, 265, 266, 267, 268, 269, 270, 271, 272, 273, 274, 275, 276, 277, 278, 279, 280, 281, 282, 283, 284, 285, 286, 287, 288, 289, 290, 291, 292, 293, 294, 295, 296, 297, 298, 299, 300, 301, 302, 303, 304, 305, 306, 307, 308, 309, 310, 311, 312, 313, 314, 315, 316, 317, 318, 319, 320, 321, 322, 323, 324, 325, 326, 327, 328, 329, 330, 331, 332, 333, 334, 335, 336, 337, 338, 339, 340, 341, 342, 343, 344, 345, 346, 347, 348, 349, 350, 351, 352, 353, 354, 355, 356, 357, 358, 359, 360, 361, 362, 363, 364, 365, 366, 367, 368, 369, 370, 371, 372, 373, 374, 375, 376, 377, 378, 379, 380, 381, 382, 383, 384, 385, 386, 387, 388, 389, 390, 391, 392, 393, 394, 395, 396, 397, 398, 399, 400, 401, 402, 403, 404, 405, 406, 407, 408, 409, 410, 411, 412, 413, 414, 415, 416, 417, 418, 419, 420, 421, 422, 423, 424, 425, 426, 427, 428, 429, 430, 431, 432, 433, 434, 435, 436, 437, 438, 439, 440, 441, 442, 443, 444, 445, 446, 447, 448, 449, 450, 451, 452, 453, 454, 455, 456, 457, 458, 459, 460, 461, 462, 463, 464, 465, 466, 467, 468, 469, 470, 471, 472, 473, 474, 475, 476, 477, 478, 479, 480, 481, 482, 483, 484, 485, 486, 487, 488, 489, 490, 491, 492, 493, 494, 495, 496, 497, 498, 499, 500, 501, 502, 503, 504, 505, 506, 507, 508, 509, 510, 511, 512, 513, 514, 515, 516, 517, 518, 519, 520, 521, 522, 523, 524, 525, 526, 527, 528, 529, 530, 531, 532, 533, 534, 535, 536, 537, 538, 539, 540, 541, 542, 543, 544, 545, 546, 547, 548, 549, 550, 551, 552, 553, 554, 555, 556, 557, 558, 559, 560, 561, 562, 563, 564, 565, 566, 567, 568, 569, 570, 571, 572, 573, 574, 575, 576, 577, 578, 579, 580, 581, 582, 583, 584, 585, 586, 587, 588, 589, 590, 591, 592, 593, 594, 595, 596, 597, 598, 599, 600, 601, 602, 603, 604, 605, 606, 607, 608, 609, 610, 611, 612, 613, 614, 615, 616, 617, 618, 619, 620, 621, 622, 623, 624, 625, 626, 627, 628, 629, 630, 631, 632, 633, 634, 635, 636, 637, 638, 639, 640, 641, 642, 643, 644, 645, 646, 647, 648, 649, 650, 651, 652, 653, 654, 655, 656, 657, 658, 659, 660, 661, 662, 663, 664, 665, 666, 667, 668, 669, 670, 671, 672, 673, 674, 675, 676, 677, 678, 679, 680, 681, 682, 683, 684, 685, 686, 687, 688, 689, 690, 691, 692, 693, 694, 695, 696, 697, 698, 699, 700, 701, 702, 703, 704, 705, 706, 707, 708, 709, 710, 711, 712, 713, 714, 715, 716, 717, 718, 719, 720, 721, 722, 723, 724, 725, 726, 727, 728, 729, 730, 731, 732, 733, 734, 735, 736, 737, 738, 739, 740, 741, 742, 743, 744, 745, 746, 747, 748, 749, 750, 751, 752, 753, 754, 755, 756, 757, 758, 759, 760, 761, 762, 763, 764, 765, 766, 767, 768, 769, 770, 771, 772, 773, 774, 775, 776, 777, 778, 779, 780, 781, 782, 783, 784, 785, 786, 787, 788, 789, 790, 791, 792, 793, 794, 795, 796, 797, 798, 799, 800, 801, 802, 803, 804, 805, 806, 807, 808, 809, 810, 811, 812, 813, 814, 815, 816, 817, 818, 819, 820, 821, 822, 823, 824, 825, 826, 827, 828, 829, 830, 831, 832, 833, 834, 835, 836, 837, 838, 839, 840, 841, 842, 843, 844, 845, 846, 847, 848, 849, 850, 851, 852, 853, 854, 855, 856, 857, 858, 859, 860, 861, 862, 863, 864, 865, 866, 867, 868, 869, 870, 871, 872, 873, 874, 875, 876, 877, 878, 879, 880, 881, 882, 883, 884, 885, 886, 887, 888, 889, 890, 891, 892, 893, 894, 895, 896, 897, 898, 899, 900, 901, 902, 903, 904, 905, 906, 907, 908, 909, 910, 911, 912, 913, 914, 915, 916, 917, 918, 919, 920, 921, 922, 923, 924, 925, 926, 927, 928, 929, 930, 931, 932, 933, 934, 935, 936, 937, 938, 939, 940, 941, 942, 943, 944, 945, 946, 947, 948, 949, 950, 951, 952, 953, 954, 955, 956, 957, 958, 959, 960, 961, 962, 963, 964, 965, 966, 967, 968, 969, 970, 971, 972, 973, 974, 975, 976, 977, 978, 979, 980, 981, 982, 983, 984, 985, 986, 987, 988, 989, 990, 991, 992, 993, 994, 995, 996, 997, 998, 999, 1000

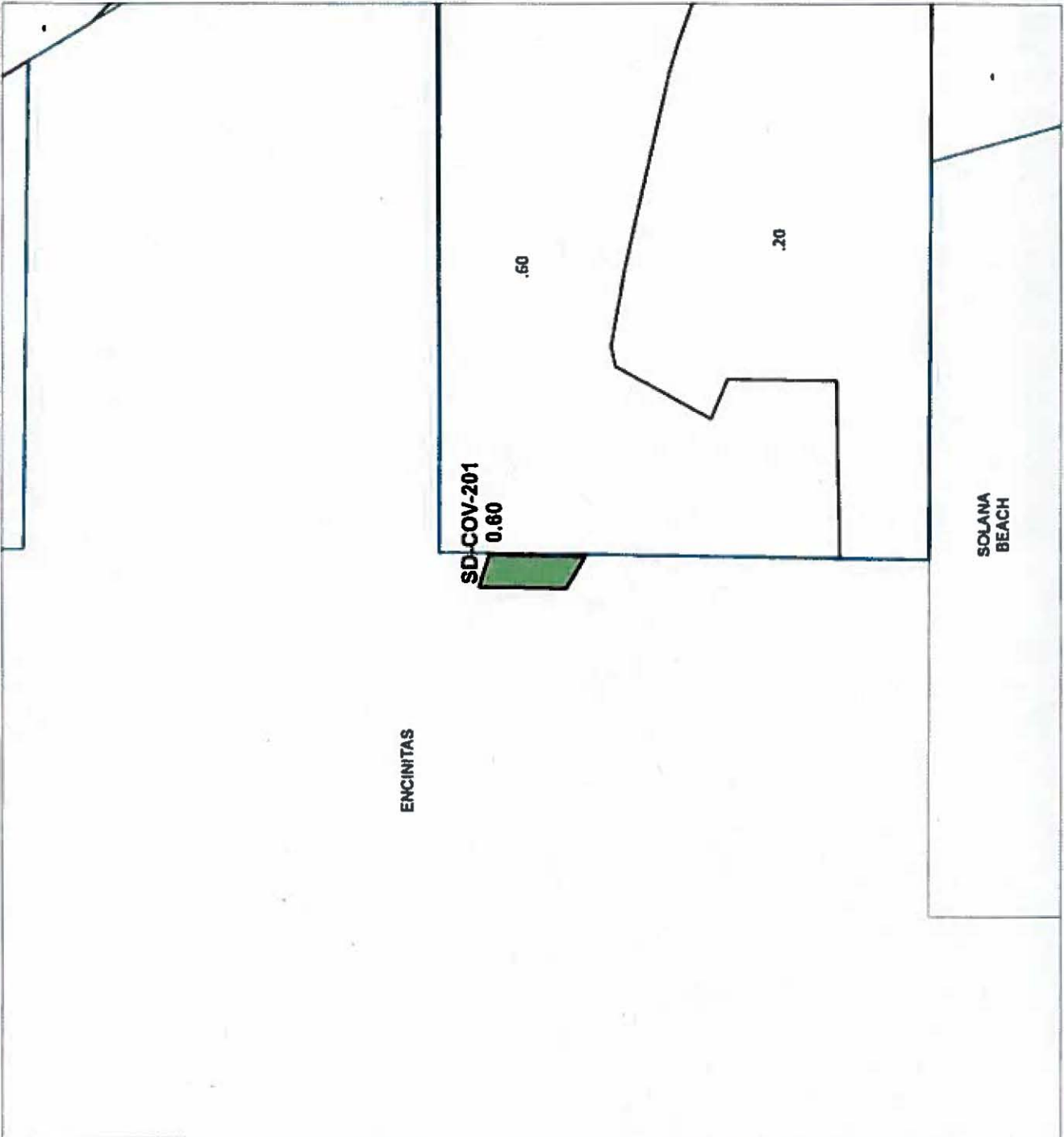

ENCINITAS

SD-COV-201  
0.60

.60

.20

SOLANA  
BEACH

COUNTY OF SAN DIEGO  
*San Diego*

- Legend
- Proposed Lot Size Regulations (Area of Change)
  - Existing Use Regulation (No Change)
  - Planning Boundary
  - Assessor Parcel
  - Water
  - Beach

Parcel Number(s)  
SD0713700

zoning map amendments  
 Ordinance 175, 194, 195, 196, 197, 198, 199, 200, 201, 202, 203, 204, 205, 206, 207, 208, 209, 210, 211, 212, 213, 214, 215, 216, 217, 218, 219, 220, 221, 222, 223, 224, 225, 226, 227, 228, 229, 230, 231, 232, 233, 234, 235, 236, 237, 238, 239, 240, 241, 242, 243, 244, 245, 246, 247, 248, 249, 250, 251, 252, 253, 254, 255, 256, 257, 258, 259, 260, 261, 262, 263, 264, 265, 266, 267, 268, 269, 270, 271, 272, 273, 274, 275, 276, 277, 278, 279, 280, 281, 282, 283, 284, 285, 286, 287, 288, 289, 290, 291, 292, 293, 294, 295, 296, 297, 298, 299, 300, 301, 302, 303, 304, 305, 306, 307, 308, 309, 310, 311, 312, 313, 314, 315, 316, 317, 318, 319, 320, 321, 322, 323, 324, 325, 326, 327, 328, 329, 330, 331, 332, 333, 334, 335, 336, 337, 338, 339, 340, 341, 342, 343, 344, 345, 346, 347, 348, 349, 350, 351, 352, 353, 354, 355, 356, 357, 358, 359, 360, 361, 362, 363, 364, 365, 366, 367, 368, 369, 370, 371, 372, 373, 374, 375, 376, 377, 378, 379, 380, 381, 382, 383, 384, 385, 386, 387, 388, 389, 390, 391, 392, 393, 394, 395, 396, 397, 398, 399, 400, 401, 402, 403, 404, 405, 406, 407, 408, 409, 410, 411, 412, 413, 414, 415, 416, 417, 418, 419, 420, 421, 422, 423, 424, 425, 426, 427, 428, 429, 430, 431, 432, 433, 434, 435, 436, 437, 438, 439, 440, 441, 442, 443, 444, 445, 446, 447, 448, 449, 450, 451, 452, 453, 454, 455, 456, 457, 458, 459, 460, 461, 462, 463, 464, 465, 466, 467, 468, 469, 470, 471, 472, 473, 474, 475, 476, 477, 478, 479, 480, 481, 482, 483, 484, 485, 486, 487, 488, 489, 490, 491, 492, 493, 494, 495, 496, 497, 498, 499, 500, 501, 502, 503, 504, 505, 506, 507, 508, 509, 510, 511, 512, 513, 514, 515, 516, 517, 518, 519, 520, 521, 522, 523, 524, 525, 526, 527, 528, 529, 530, 531, 532, 533, 534, 535, 536, 537, 538, 539, 540, 541, 542, 543, 544, 545, 546, 547, 548, 549, 550, 551, 552, 553, 554, 555, 556, 557, 558, 559, 560, 561, 562, 563, 564, 565, 566, 567, 568, 569, 570, 571, 572, 573, 574, 575, 576, 577, 578, 579, 580, 581, 582, 583, 584, 585, 586, 587, 588, 589, 590, 591, 592, 593, 594, 595, 596, 597, 598, 599, 600, 601, 602, 603, 604, 605, 606, 607, 608, 609, 610, 611, 612, 613, 614, 615, 616, 617, 618, 619, 620, 621, 622, 623, 624, 625, 626, 627, 628, 629, 630, 631, 632, 633, 634, 635, 636, 637, 638, 639, 640, 641, 642, 643, 644, 645, 646, 647, 648, 649, 650, 651, 652, 653, 654, 655, 656, 657, 658, 659, 660, 661, 662, 663, 664, 665, 666, 667, 668, 669, 670, 671, 672, 673, 674, 675, 676, 677, 678, 679, 680, 681, 682, 683, 684, 685, 686, 687, 688, 689, 690, 691, 692, 693, 694, 695, 696, 697, 698, 699, 700, 701, 702, 703, 704, 705, 706, 707, 708, 709, 710, 711, 712, 713, 714, 715, 716, 717, 718, 719, 720, 721, 722, 723, 724, 725, 726, 727, 728, 729, 730, 731, 732, 733, 734, 735, 736, 737, 738, 739, 740, 741, 742, 743, 744, 745, 746, 747, 748, 749, 750, 751, 752, 753, 754, 755, 756, 757, 758, 759, 760, 761, 762, 763, 764, 765, 766, 767, 768, 769, 770, 771, 772, 773, 774, 775, 776, 777, 778, 779, 780, 781, 782, 783, 784, 785, 786, 787, 788, 789, 790, 791, 792, 793, 794, 795, 796, 797, 798, 799, 800, 801, 802, 803, 804, 805, 806, 807, 808, 809, 810, 811, 812, 813, 814, 815, 816, 817, 818, 819, 820, 821, 822, 823, 824, 825, 826, 827, 828, 829, 830, 831, 832, 833, 834, 835, 836, 837, 838, 839, 840, 841, 842, 843, 844, 845, 846, 847, 848, 849, 850, 851, 852, 853, 854, 855, 856, 857, 858, 859, 860, 861, 862, 863, 864, 865, 866, 867, 868, 869, 870, 871, 872, 873, 874, 875, 876, 877, 878, 879, 880, 881, 882, 883, 884, 885, 886, 887, 888, 889, 890, 891, 892, 893, 894, 895, 896, 897, 898, 899, 900, 901, 902, 903, 904, 905, 906, 907, 908, 909, 910, 911, 912, 913, 914, 915, 916, 917, 918, 919, 920, 921, 922, 923, 924, 925, 926, 927, 928, 929, 930, 931, 932, 933, 934, 935, 936, 937, 938, 939, 940, 941, 942, 943, 944, 945, 946, 947, 948, 949, 950, 951, 952, 953, 954, 955, 956, 957, 958, 959, 960, 961, 962, 963, 964, 965, 966, 967, 968, 969, 970, 971, 972, 973, 974, 975, 976, 977, 978, 979, 980, 981, 982, 983, 984, 985, 986, 987, 988, 989, 990, 991, 992, 993, 994, 995, 996, 997, 998, 999, 1000





COUNTY OF SAN DIEGO  
San Diego

- LEGEND**
- Proposed Open Space Reservations (Areas of Change)
  - Existing Use Repeal (Use Change)
  - Planning Boundary
  - Assessor Parcels
  - Leaves
  - Roads

Project: NCTP131  
3630713700

Zone: Use Repeal  
Reference: PD 04, 05, 06, 07, 08, 09, 10, 11, 12, 13, 14, 15, 16, 17, 18, 19, 20, 21, 22, 23, 24, 25, 26, 27, 28, 29, 30, 31, 32, 33, 34, 35, 36, 37, 38, 39, 40, 41, 42, 43, 44, 45, 46, 47, 48, 49, 50, 51, 52, 53, 54, 55, 56, 57, 58, 59, 60, 61, 62, 63, 64, 65, 66, 67, 68, 69, 70, 71, 72, 73, 74, 75, 76, 77, 78, 79, 80, 81, 82, 83, 84, 85, 86, 87, 88, 89, 90, 91, 92, 93, 94, 95, 96, 97, 98, 99, 100

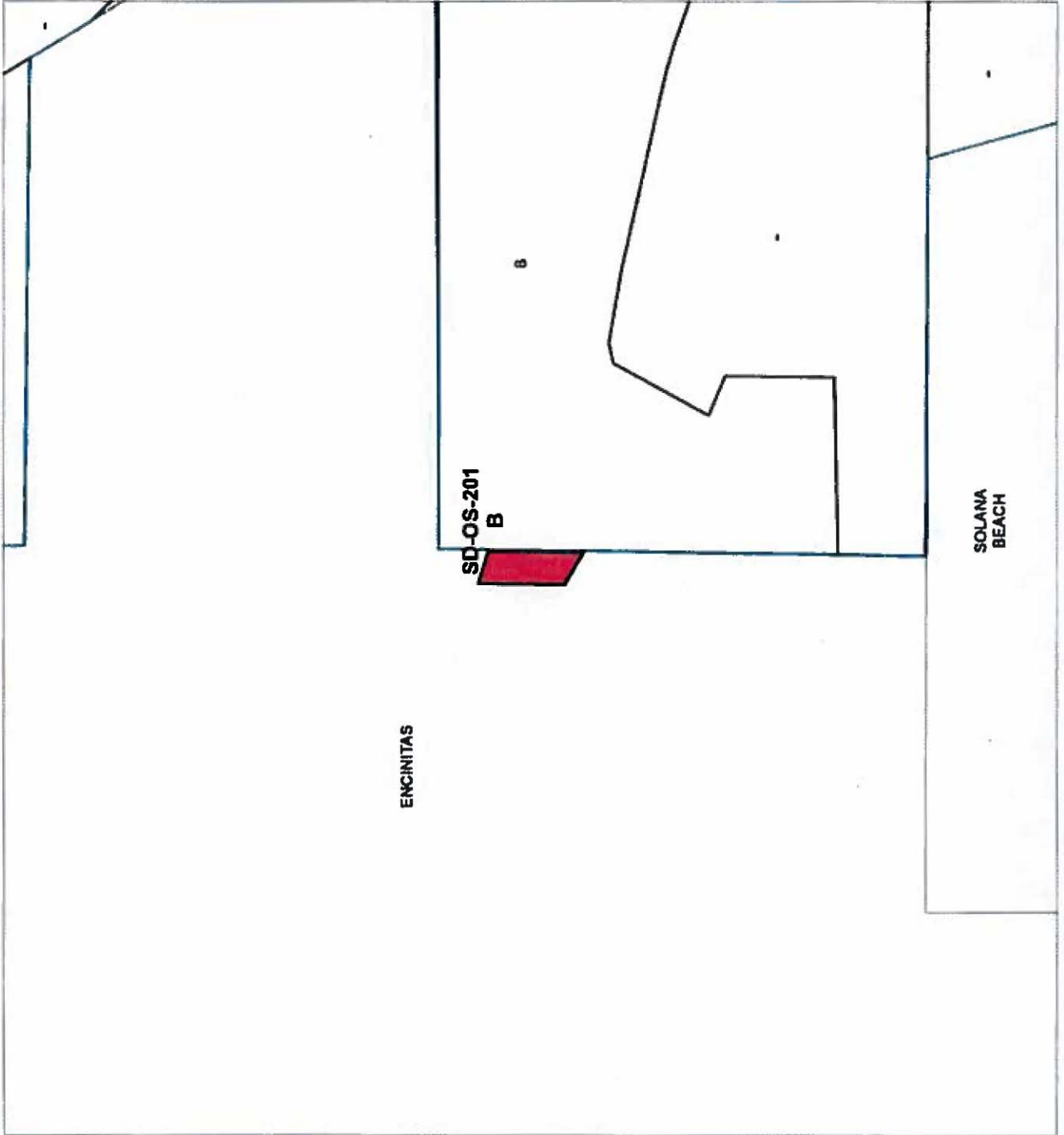





COUNTY OF SAN DIEGO  
*San Diego*

- Legend
- Proposed Special Repealors (Area of Change)
  - Existing Use Repealors (the Change)
  - Planning Boundary
  - Assessor Parcels
  - Leaves
  - Reeds

Print Number(s)  
2520113700

County Use Repealors  
Repealors are the areas that are being repealed.  
Repealors are the areas that are being repealed.  
Repealors are the areas that are being repealed.  
Repealors are the areas that are being repealed.  
Repealors are the areas that are being repealed.

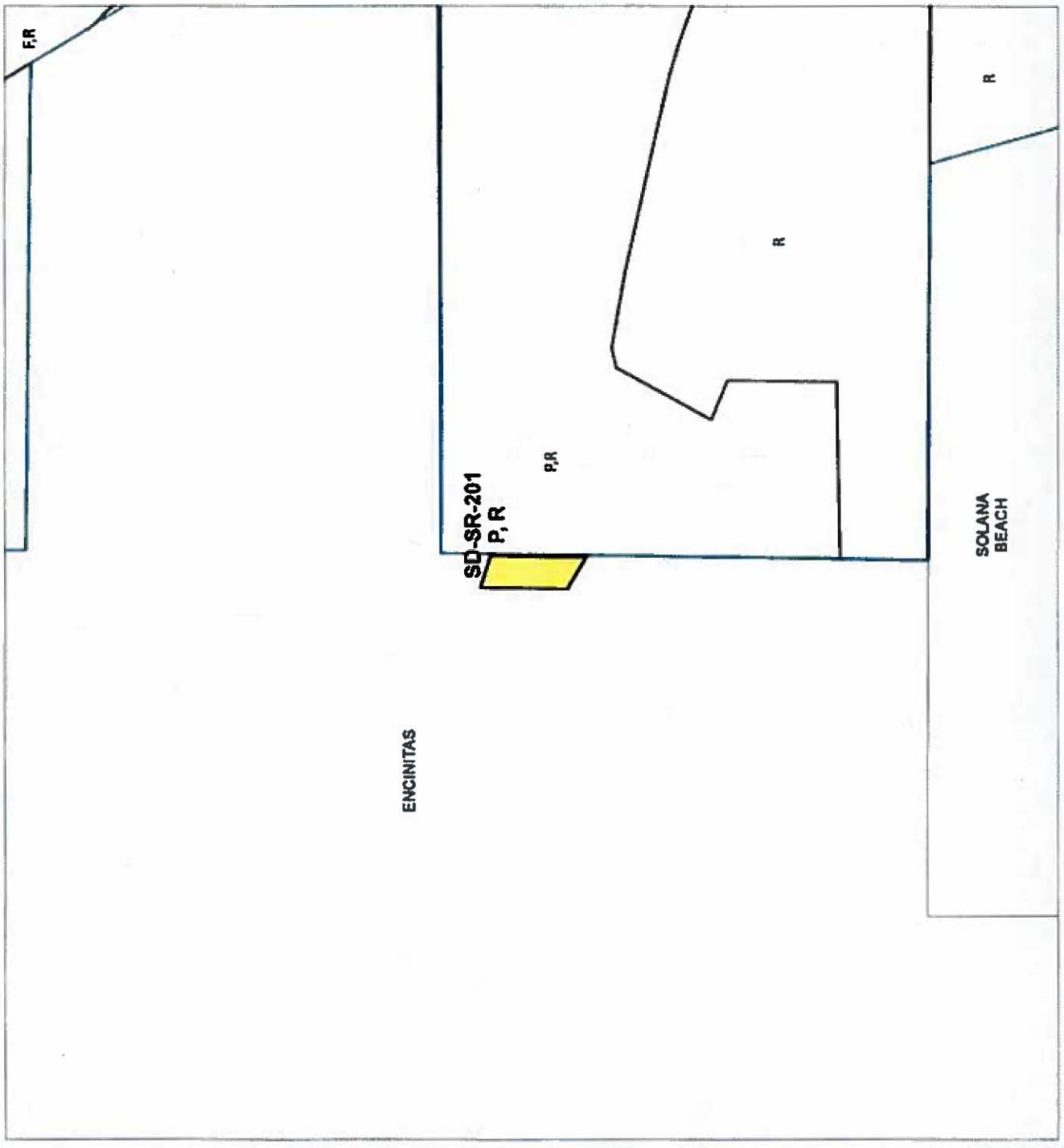

COUNTY OF SAN DIEGO  
San Diego

- Legend
- Proposed Use Regulations (Areas of Change)
  - Existing Use Regulation (No Change)
  - Planning Boundary
  - Assessor's Parcel
  - Labels
  - Notes

Parcel Number(s)  
300713700

General Use Regulations  
Permitted for use in the following areas:  
1. Areas of Change  
2. Areas of No Change  
3. Areas of Conditional Use  
4. Areas of Conditional Use  
5. Areas of Conditional Use  
6. Areas of Conditional Use  
7. Areas of Conditional Use  
8. Areas of Conditional Use  
9. Areas of Conditional Use  
10. Areas of Conditional Use



A70

ENCINITAS

SD-UR-201  
RV

RV

RS

RS

SOLANA  
BEACH