

**RECORDING
NOT REQUIRED**

RETURN TO:

**CITY CLERK OF TROY
116 E. MARKET STREET
TROY, IL 62294**

**CITY OF TROY
RESOLUTION 2025-35**

**A RESOLUTION OF THE CITY OF TROY, ILLINOIS
AUTHORIZING THE MAYOR TO EXECUTE A JURISDICTION AND
MAINTENANCE AGREEMENT WITH THE
ILLINOIS DEPARTMENT OF TRANSPORTATION**

**ADOPTED BY THE CITY COUNCIL OF THE
CITY OF TROY, ILLINOIS
THIS 15TH DAY OF DECEMBER 2025**

RESOLUTION NO. 2025 - 35

A RESOLUTION OF THE CITY OF TROY, ILLINOIS AUTHORIZING THE MAYOR TO EXECUTE A JURISDICTION AND MAINTENANCE AGREEMENT WITH THE ILLINOIS DEPARTMENT OF TRANSPORTATION

WHEREAS, THE City Council for the City of Troy, Illinois, believes that it is in the best interest of the City and its citizens to enter into a Jurisdiction and Maintenance Agreement with the Illinois Department of Transportation to ensure proper maintenance at a roundabout to be constructed on Illinois Route 162 and Old Troy Road; and

WHEREAS, the Jurisdiction and Maintenance Agreement is attached hereto and incorporated herein as "Schedule 6", and the City believes that such terms and conditions are in the best interest of the health, safety and general welfare of its citizens.

NOW, THEREFORE, BE IT ORDAINED BY THE MAYOR AND CITY COUNCIL OF THE CITY OF TROY, ILLINOIS, AS FOLLOWS:

1. The recitals set forth above are true and accurate and are hereby incorporated by reference.
2. The Mayor of the City of Troy, Illinois, is hereby authorized to execute and enter into the attached Jurisdiction and Maintenance Agreement with the Illinois Department of Transportation and is further authorized to take all actions and sign all documents necessary to fulfill the intent of this resolution.
3. This Resolution shall be effective upon its passage, signing and publication as required by law.

PASSED by the City Council of the City of Troy, Madison County, Illinois, approved by the Mayor, and deposited in the office of the City Clerk this 15th day of December, 2025.

Aldermen:

Dan Dawson	<u>✓</u>	Sam Italiano	<u>✓</u>	Ayes:	<u>8</u>
Tim Flint	<u>✓</u>	Debbie Knoll	<u>✓</u>	Nays:	<u>0</u>
Elizabeth Hellrung	<u>✓</u>	Heather Stirling	<u>✓</u>	Absent:	<u>0</u>
Nathan Henderson	<u>✓</u>	Troy Turner	<u>✓</u>	Abstain:	<u>0</u>

APPROVED

By: David Nonn
DAVID NONN, Mayor
City of Troy, Illinois

ATTEST:

By: Kimberly Thomas
KIMBERLY THOMAS, Clerk
City of Troy, Illinois



Schedule 6

City of Troy
Section 17-00034-00-PV
IL Route 162 & Old Troy Road Roundabout
Jurisdiction and Maintenance Agreement

It is MUTUALLY agreed:

1. The STATE hereby agrees that upon final field inspection of the improvement and so long as IL Route 162 is used as a State Highway that they will maintain or cause to be maintained those items they currently maintain or that are being installed under this project on STATE right-of-way:
 1. through lanes and shoulders of IL Route 162;
 2. driving lanes on roundabout; raised medians (splitter islands) on State Highways; truck aprons;
 3. signage along legs of IL Route 162;
 4. pavement markings on IL Route 162.

2. The LOCAL AGENCY (City of Troy) hereby agrees to maintain or cause to maintain, within the project limits:
 1. all curb and gutter along IL Route 162 east of the driving lanes on the roundabout;
 2. storm sewers, manholes and catch basins along IL Route 162 east of the driving lanes on the roundabout;
 3. entrances from the edge of pavement to right-of-way line;
 4. highway lighting along IL Route 162 east of the driving lanes on the roundabout;
 5. furnishing the electrical energy for all legs of the roundabout therefore;
 6. Local Agency owned utilities including appurtenances there to;
 7. other appurtenances outside of what is described above related to the project.

3. The LOCAL AGENCY (Village of Maryville) hereby agrees to maintain or cause to maintain, within the project limits:
 1. all curb and gutter along IL Route 162 west of the driving lanes on the roundabout;
 2. storm sewers, manholes and catch basins along IL Route 162 west of the driving lanes on the roundabout;
 3. highway lighting gutter along IL Route 162 west of the driving lanes on the roundabout;
 4. landscaping and/or landscaping rock within center of roundabout;
 5. Local Agency owned utilities including appurtenances there to;
 6. other appurtenances outside of what is described above related to the project.

4. The LOCAL AGENCY (Collinsville Township) hereby agrees to maintain or cause to maintain, within the project limits:
 1. Old Troy Road up to the edge of pavement of IL Route 162 including the splitter island);
 2. all curb and gutter along Old Troy Road north of the driving lanes on the roundabout;
 3. storm sewers, manholes and catch basins along Old Troy Road north of the driving lanes on the roundabout;
 4. crosswalks and yield bars on Old Troy Road
 5. sidewalks, curb ramps and other pedestrian accommodations;
 6. highway lighting along Old Troy Road north of the driving lanes on the roundabout;
 7. Local Agency owned utilities including appurtenances there to;
 8. other appurtenances outside of what is described above related to the project.

See attached Maintenance Limits Exhibit for more defined limits.

This addendum shall be binding upon and to the benefit of the parties hereto, their successors and assigns.

CITY OF TROY

Name David Nonn
Title Mayor
Signature *David Nonn*
Date 17 DEC 2025

VILLAGE OF MARYVILLE

Name Wayne White
Title Mayor
Signature _____
Date _____

COLLINSVILLE TOWNSHIP

Name Kathy Trucano-Hoelscher
Title Highway Commissioner
Signature _____
Date _____

This addendum shall be binding upon and to the benefit of the parties hereto, their successors and assigns.

CITY OF TROY

Name David Nonn
Title Mayor
Signature *David Nonn*
Date 17 Dec 2025

VILLAGE OF MARYVILLE

Name Wayne White
Title Mayor
Signature *Wayne White*
Date 12/4/2025

COLLINSVILLE TOWNSHIP

Name Kathy Trucano-Hoelscher
Title Highway Commissioner
Signature _____
Date _____

See attached Maintenance Limits Exhibit for more defined limits.

This addendum shall be binding upon and to the benefit of the parties hereto, their successors and assigns.

CITY OF TROY

Name David Nonn
Title Mayor
Signature David Nonn
Date 17 DEC 2025

VILLAGE OF MARYVILLE

Name Wayne White
Title Mayor
Signature _____
Date _____

COLLINSVILLE TOWNSHIP

Name Kathy Trucano-Hoelscher
Title Highway Commissioner
Signature Kathy Trucano-Hoelscher
Date 11-26-2025

YELLOW IS IDOT MAINTENANCE

RED IS TROY MAINTENANCE

GREEN IS MARYVILLE MAINTENANCE

PURPLE IS COLLINSVILLE TOWNSHIP MAINTENANCE

GENERAL NOTES (THIS SHEET):

- THE PROPOSED ROUTING OF PROPOSED ELECTRICAL CIRCUITS AND LOCATIONS OF PROPOSED JUNCTION BOXES SHOWN ON THE PLAN SHEET ARE SCHEMATIC, AND THEREFORE MAY REQUIRE FIELD ADJUSTMENTS. THE PROPOSED CIRCUIT AND JUNCTION BOX LOCATIONS MAY BE ADJUSTED, AS NECESSARY, DUE TO THE PRESENCE OF EXISTING UTILITIES, OTHER ABOVEGROUND APPURTENANCES OR TOPOGRAPHY.
- RIGHT POLE LOCATIONS MAY BE ADJUSTED IN THE FIELD, IF NECESSARY, DUE TO THE PRESENCE OF EXISTING UTILITIES, OTHER ABOVEGROUND APPURTENANCES, OR TOPOGRAPHY. HOWEVER, THE CONTRACTOR SHALL COORDINATE FINAL LOCATIONS OF ALL LIGHT POLE FOUNDATIONS WITH THE CITY ENGINEER. CONTRACTOR SHALL ENSURE ALL PROPOSED FOUNDATIONS ARE INSTALLED IN LOCATIONS THAT WILL PROVIDE NO LESS THAN 3 FT. SEPARATION BETWEEN BACK OF CURB AND CENTER OF THE PROPOSED LIGHT POLE, UNLESS OTHERWISE DIRECTED BY THE ENGINEER.
- DELETED LIGHT POLE ASSEMBLY SHALL INCLUDE A HOUSE SIDE SHIELD FOR THE LUMINAIRE.

IL ROUTE 162
IMPROVEMENT BEGINS
STA 541+50.27

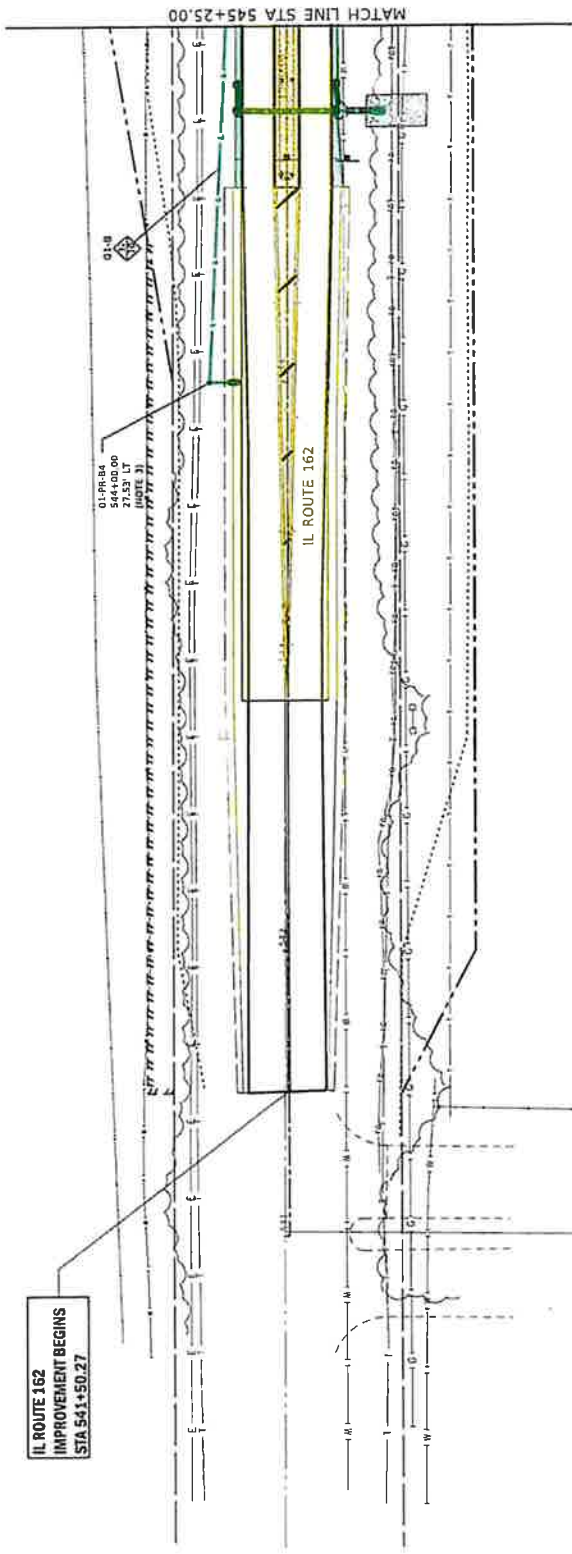

MATCH LINE STA 545+25.00

UTILITY NOTE:
 ALL EXISTING UTILITIES SHOWN WERE PLOTTED FROM AVAILABLE INFORMATION AND DO NOT NECESSARILY REFLECT THE ACTUAL EXISTENCE, NON-EXISTENCE, SIZE, TYPE, NUMBER OR LOCATION OF THESE OR OTHER UTILITIES. THE CONTRACTOR SHALL BE RESPONSIBLE FOR VERIFYING THE LOCATION AND DEPTH OF ALL UTILITIES IN THE FIELD PRIOR TO ANY GRADING, EXCAVATION OR CONSTRUCTION IMPROVEMENTS.

DESIGNED BY	DATE
DRAWN BY	DATE
CHECKED BY	DATE

REVISION	DATE
REVISION	DATE
REVISION	DATE

STATE OF ILLINOIS
 DEPARTMENT OF TRANSPORTATION

LIGHTING PLANS
 IL ROUTE 162 AND OLD TROY ROAD

SHEET	OF	SHEETS	STATION	SP-SHEETS TO STATION
1	4	4	541+50.27	545+25.00

MAINTENANCE LIMITS EXHIBIT
 1 OF 4



DATE	SCALE	PROJECT
05/20/2014	1"=20'-0"	IL ROUTE 162 AND OLD TROY ROAD

GENERAL NOTES (THIS SHEET):

1. DEDICATED PROPOSED POWER POLE ASSUMED SERVICE DROPT LOCATION. COORDINATION WITH AMEREN ILLINOIS IS REQUIRED TO VERIFY FINAL LOCATION FOR NEW ELECTRIC SERVICE DROPT.
2. A TOTAL OF FOUR 2-INCH PVC CONDUITS ARE TO BE INSTALLED BETWEEN PROPOSED OUTLOOK ADAPTATION (COMPOSITE CONCRETE) AND PROPOSED LIGHTING CONTROLLER. ONE 2-INCH CONDUIT IS TO BE PROVIDED FOR EACH CIRCUIT AND ONE 2 INCH CONDUIT SHALL BE PROVIDED AS A SPARE CONDUIT FOR FUTURE USE.
3. THE PROPOSED ROUTING OF PROPOSED ELECTRICAL CIRCUITS AND LOCATIONS OF PROPOSED JUNCTION BOXES SHOWN ON THIS PLAN SHEET ARE SCHEMATIC AND THEREFORE MAY REQUIRE FIELD ADJUSTMENTS. THE PROPOSED CIRCUIT AND JUNCTION BOX LOCATIONS MAY VARY FROM THE SCHEMATIC DUE TO THE PRESENCE OF EXISTING UTILITIES, OTHER ABOVEGROUND OR UNDERGROUND UTILITIES, OBSTRUCTIONS, OR TOPOGRAPHY.
4. LIGHT POLE LOCATIONS MAY BE ADJUSTED IN THE FIELD IF NECESSARY DUE TO THE PRESENCE OF EXISTING UTILITIES, OTHER ABOVEGROUND OR UNDERGROUND UTILITIES, OBSTRUCTIONS, OR TOPOGRAPHY. THE CITY OF HUNTSVILLE CONSTRUCTION REPRESENTATIVE AFTER ALL UTILITIES HAVE BEEN FIELD LOCATED AND/OR EXPOSED. CONTRACTOR SHALL ENSURE ALL PROPOSED FOUNDATIONS ARE INSTALLED IN LOCATIONS THAT WILL PROVIDE 10:15% TO 3% H-1 SLOPE AND BE WITHIN BACK-OF-CURB (BOC) CENTER OF THE PROPOSED LIGHT POLE, UNLESS OTHERWISE DIRECTED BY THE ENGINEER.
5. DEDICATED LIGHT POLE ASSEMBLY SHALL INCLUDE A HOUSE SIDE SHIELD FOR THE LUMINAIRE.
6. DEDICATED PROPOSED REMEDIATION AND/OR PROTECTION SHALL BE INSTALLED FOR THE FEEDING ELECTRICAL SYSTEM USE PURPOSES.

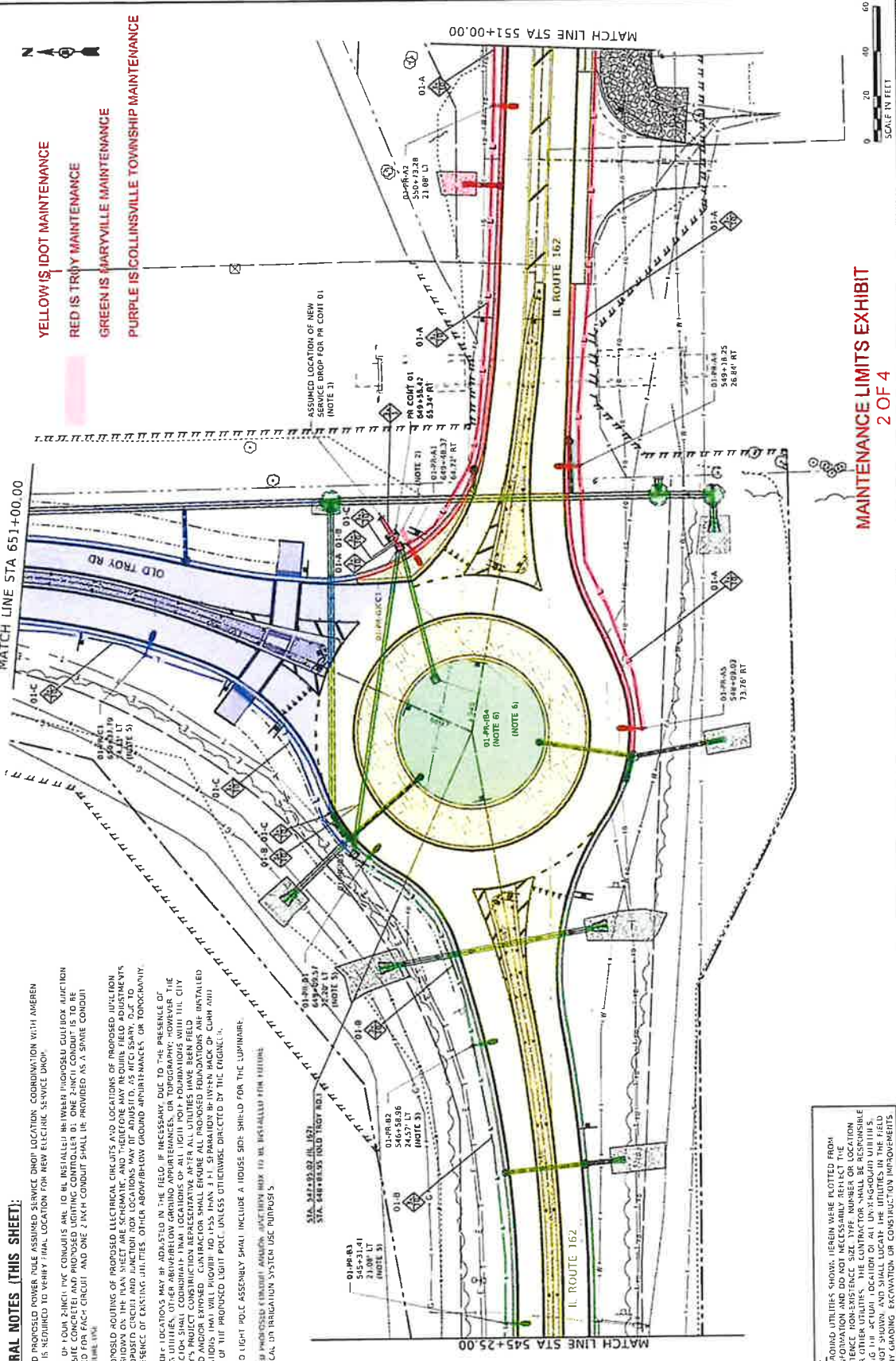

MAINTENANCE LIMITS EXHIBIT
2 OF 4

STATE OF ILLINOIS
DEPARTMENT OF TRANSPORTATION

LIGHTING PLANS
IL ROUTE 162 AND OLD TROY ROAD

DESIGNED BY	DATE	REVISION	DATE
DRAWN BY	DATE	REVISION	DATE
CHECKED BY	DATE	REVISION	DATE
IN CHARGE BY	DATE	REVISION	DATE



PROJECT NO. 11-0000-0000
SHEET NO. 11-0000-0000
DATE: 11/11/2011

SCALE: 1"=40'
SHEET 2 OF 4

CONTRACT NO. 11-0000-0000
SHEET NO. 11-0000-0000

DATE: 11/11/2011

SCALE: 1"=40'

SHEET 2 OF 4

CONTRACT NO. 11-0000-0000

SHEET NO. 11-0000-0000

DATE: 11/11/2011

SCALE: 1"=40'

SHEET 2 OF 4

CONTRACT NO. 11-0000-0000

SHEET NO. 11-0000-0000

DATE: 11/11/2011

SCALE: 1"=40'

SHEET 2 OF 4

CONTRACT NO. 11-0000-0000

SHEET NO. 11-0000-0000

DATE: 11/11/2011

SCALE: 1"=40'

SHEET 2 OF 4

CONTRACT NO. 11-0000-0000

SHEET NO. 11-0000-0000

DATE: 11/11/2011

SCALE: 1"=40'

SHEET 2 OF 4

CONTRACT NO. 11-0000-0000

SHEET NO. 11-0000-0000

DATE: 11/11/2011

SCALE: 1"=40'

SHEET 2 OF 4

CONTRACT NO. 11-0000-0000

SHEET NO. 11-0000-0000

DATE: 11/11/2011

SCALE: 1"=40'

SHEET 2 OF 4

CONTRACT NO. 11-0000-0000

SHEET NO. 11-0000-0000

DATE: 11/11/2011

SCALE: 1"=40'

SHEET 2 OF 4

CONTRACT NO. 11-0000-0000

SHEET NO. 11-0000-0000

DATE: 11/11/2011

SCALE: 1"=40'

SHEET 2 OF 4

CONTRACT NO. 11-0000-0000

SHEET NO. 11-0000-0000

DATE: 11/11/2011

SCALE: 1"=40'

SHEET 2 OF 4

CONTRACT NO. 11-0000-0000

SHEET NO. 11-0000-0000

DATE: 11/11/2011

SCALE: 1"=40'

SHEET 2 OF 4

CONTRACT NO. 11-0000-0000

SHEET NO. 11-0000-0000

DATE: 11/11/2011

SCALE: 1"=40'

SHEET 2 OF 4

CONTRACT NO. 11-0000-0000

SHEET NO. 11-0000-0000

DATE: 11/11/2011

SCALE: 1"=40'

SHEET 2 OF 4

CONTRACT NO. 11-0000-0000

SHEET NO. 11-0000-0000

DATE: 11/11/2011

SCALE: 1"=40'

SHEET 2 OF 4

CONTRACT NO. 11-0000-0000

SHEET NO. 11-0000-0000

DATE: 11/11/2011

SCALE: 1"=40'

SHEET 2 OF 4

CONTRACT NO. 11-0000-0000

SHEET NO. 11-0000-0000

DATE: 11/11/2011

SCALE: 1"=40'

SHEET 2 OF 4

CONTRACT NO. 11-0000-0000

SHEET NO. 11-0000-0000

DATE: 11/11/2011

SCALE: 1"=40'

SHEET 2 OF 4

CONTRACT NO. 11-0000-0000

SHEET NO. 11-0000-0000

DATE: 11/11/2011

SCALE: 1"=40'

SHEET 2 OF 4

CONTRACT NO. 11-0000-0000

SHEET NO. 11-0000-0000

DATE: 11/11/2011

SCALE: 1"=40'

SHEET 2 OF 4

CONTRACT NO. 11-0000-0000

SHEET NO. 11-0000-0000

DATE: 11/11/2011

SCALE: 1"=40'

SHEET 2 OF 4

CONTRACT NO. 11-0000-0000

SHEET NO. 11-0000-0000

DATE: 11/11/2011

SCALE: 1"=40'

SHEET 2 OF 4

CONTRACT NO. 11-0000-0000

SHEET NO. 11-0000-0000

DATE: 11/11/2011

SCALE: 1"=40'

SHEET 2 OF 4

CONTRACT NO. 11-0000-0000

SHEET NO. 11-0000-0000

DATE: 11/11/2011

SCALE: 1"=40'

SHEET 2 OF 4

CONTRACT NO. 11-0000-0000

SHEET NO. 11-0000-0000

DATE: 11/11/2011

SCALE: 1"=40'

SHEET 2 OF 4

CONTRACT NO. 11-0000-0000

SHEET NO. 11-0000-0000

DATE: 11/11/2011

SCALE: 1"=40'

SHEET 2 OF 4

CONTRACT NO. 11-0000-0000

SHEET NO. 11-0000-0000

DATE: 11/11/2011

SCALE: 1"=40'

SHEET 2 OF 4

CONTRACT NO. 11-0000-0000

SHEET NO. 11-0000-0000

DATE: 11/11/2011

SCALE: 1"=40'

SHEET 2 OF 4

CONTRACT NO. 11-0000-0000

SHEET NO. 11-0000-0000

DATE: 11/11/2011

SCALE: 1"=40'

SHEET 2 OF 4

CONTRACT NO. 11-0000-0000

SHEET NO. 11-0000-0000

DATE: 11/11/2011

SCALE: 1"=40'

SHEET 2 OF 4

CONTRACT NO. 11-0000-0000

SHEET NO. 11-0000-0000

DATE: 11/11/2011

SCALE: 1"=40'

SHEET 2 OF 4

CONTRACT NO. 11-0000-0000

SHEET NO. 11-0000-0000

DATE: 11/11/2011

SCALE: 1"=40'

SHEET 2 OF 4

CONTRACT NO. 11-0000-0000

SHEET NO. 11-0000-0000

DATE: 11/11/2011

SCALE: 1"=40'

SHEET 2 OF 4

CONTRACT NO. 11-0000-0000

SHEET NO. 11-0000-0000

DATE: 11/11/2011

SCALE: 1"=40'

SHEET 2 OF 4

CONTRACT NO. 11-0000-0000

SHEET NO. 11-0000-0000

DATE: 11/11/2011

SCALE: 1"=40'

SHEET 2 OF 4

CONTRACT NO. 11-0000-0000

SHEET NO. 11-0000-0000

DATE: 11/11/2011

SCALE: 1"=40'

SHEET 2 OF 4

CONTRACT NO. 11-0000-0000

SHEET NO. 11-0000-0000

DATE: 11/11/2011

SCALE: 1"=40'

SHEET 2 OF 4

CONTRACT NO. 11-0000-0000

SHEET NO. 11-0000-0000

DATE: 11/11/2011

SCALE: 1"=40'

SHEET 2 OF 4

CONTRACT NO. 11-0000-0000

SHEET NO. 11-0000-0000

DATE: 11/11/2011

SCALE: 1"=40'

SHEET 2 OF 4

CONTRACT NO. 11-0000-0000

SHEET NO. 11-0000-0000

DATE: 11/11/2011

SCALE: 1"=40'

SHEET 2 OF 4

CONTRACT NO. 11-0000-0000

SHEET NO. 11-0000-0000

DATE: 11/11/2011

SCALE: 1"=40'

SHEET 2 OF 4

CONTRACT NO. 11-0000-0000

SHEET NO. 11-0000-0000

DATE: 11/11/2011

SCALE: 1"=40'

SHEET 2 OF 4

CONTRACT NO. 11-0000-0000

SHEET NO. 11-0000-0000

DATE: 11/11/2011

SCALE: 1"=40'

SHEET 2 OF 4

CONTRACT NO. 11-0000-0000

SHEET NO. 11-0000-0000

DATE: 11/11/2011

SCALE: 1"=40'

SHEET 2 OF 4

CONTRACT NO. 11-0000-0000

SHEET NO. 11-0000-0000

DATE: 11/11/2011

SCALE: 1"=40'

SHEET 2 OF 4

CONTRACT NO. 11-0000-0000

SHEET NO. 11-0000-0000

DATE: 11/11/2011

SCALE: 1"=4

GENERAL NOTES (THIS SHEET):

1. THE PROPOSED ROUTING OF PROPOSED ELECTRICAL CIRCUITS AND LOCATIONS OF PROPOSED JUNCTION BOXES SHOWN ON THE PLAN SHEET ARE SCHEMATIC, AND THEREFORE MAY REQUIRE FIELD ADJUSTMENTS. THE PROPOSED CIRCUIT AND JUNCTION BOX LOCATIONS MAY BE ADJUSTED, AS NECESSARY, DUE TO THE PRESENCE OF EXISTING UTILITIES, OTHER ABOVEGROUND UTILITIES, OR TOPOGRAPHY.
2. LIGHT POLE LOCATIONS MAY BE ADJUSTED IN THE FIELD, IF NECESSARY, DUE TO THE PRESENCE OF EXISTING UTILITIES, OTHER ABOVEGROUND UTILITIES, OR TOPOGRAPHY. HOWEVER, THE CONTRACTOR SHALL COORDINATE FINAL LOCATIONS OF ALL LIGHT POLE FOUNDATIONS WITH THE CITY OF TROY'S PROJECT ENGINEER. THE CONTRACTOR SHALL ENSURE ALL PROPOSED FOUNDATIONS ARE INSTALLED IN LOCATIONS THAT WILL PROVIDE NO LESS THAN 3 FT. SEPARATION BETWEEN BACK OF CURB AND CENTER OF THE PROPOSED LIGHT POLE, UNLESS OTHERWISE DIRECTED BY THE ENGINEER.

- YELLOW IS IDOT MAINTENANCE
- RED IS TROY MAINTENANCE
- GREEN IS MARYVILLE MAINTENANCE
- PURPLE IS COLLINSVILLE TOWNSHIP MAINTENANCE

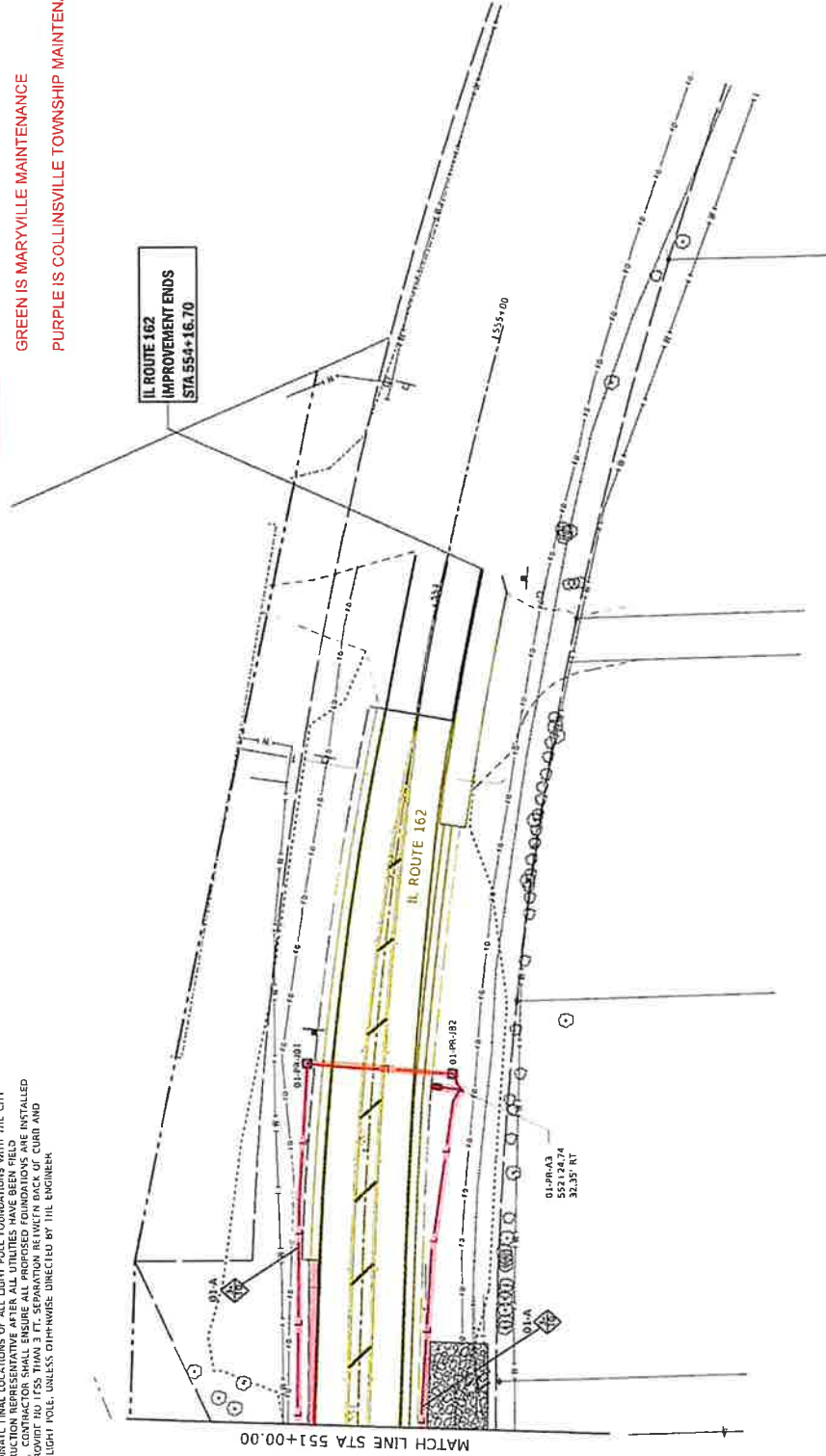

UTILITY NOTE:
 EXISTING UTILITIES SHOWN WHEREVER NOT LIST FROM AVAILABLE INFORMATION AND DO NOT NECESSARILY REFLECT THE ACTUAL EXISTENCE, NON-EXISTENCE, SIZE, TYPE, NUMBER OR LOCATION OF THESE OR OTHER UTILITIES. THE CONTRACTOR SHALL BE RESPONSIBLE FOR VERIFYING THE ACTUAL LOCATION OF ALL UTILITIES IN THE FIELD PRIOR TO ANY GRADING, EXCAVATION OR CONSTRUCTION IMPROVEMENTS.

		PREPARED BY: [Name] DRAWN BY: [Name] CHECKED BY: [Name] DATE: [Date]
STATE OF ILLINOIS DEPARTMENT OF TRANSPORTATION		LIGHTING PLANS IL ROUTE 162 AND OLD TROY ROAD SHEET 3 OF 3 SHEETS STATION 551+00.00 TO 554+16.70
COUNTY: [County] DISTRICT: [District] CONTRACT NO. 07M77	SCALE IN FEET 0 20 40 60	SECTION: [Section] SHEET: [Sheet]

**MAINTENANCE LIMITS EXHIBIT
 3 OF 4**

