

CITY OF BEDFORD, OHIO

ORDINANCE NO. 029-26

AN ORDINANCE AUTHORIZING THE CITY MANAGER TO ENTER INTO A CONTRACT WITH GAMETIME FOR THE REPLACEMENT OF PLAYGROUND EQUIPMENT AT GREENCROFT PARK AND DECLARING AN EMERGENCY

WHEREAS, the Administration recommends that GameTime replace the playground equipment at Greencroft Park, and

WHEREAS, the City was awarded a Cuyahoga County CDBG Grant in the amount of **One Hundred Fifty Thousand Dollars and Zero Cents (\$150,000.00)** for the replacement of the playground equipment at Greencroft Park, and

WHEREAS, the Administration recommends GameTime as the lowest cost for the purchase and installation of the playground equipment.

NOW, THEREFORE, BE IT ORDAINED by the Council of the City of Bedford, County of Cuyahoga, and the State of Ohio:

Section 1. The Council for the City of Bedford hereby authorizes the City Manager to enter into a contract with GameTime for the replacement of park equipment in the amount of **One Hundred Seventy Thousand Dollars and Zero Cents (\$170,000.00)**.

Section 2. The Council of the City of Bedford hereby authorizes the Finance Director to appropriate and pay **GameTime** for said playground equipment pursuant to the terms of the contract.

Section 3. That the actions of this Council concerning and relating to the passage of this legislation were adopted in an open meeting of this Council and that all deliberations of this Council and of any of its committees that resulted in such formal action were in meetings open to the public, in compliance with all legal requirements, including Section 121.22 of the Ohio Revised Code.

Section 4. This Ordinance is hereby declared to be an emergency measure immediately necessary for the public peace, health, safety, and welfare of the City of Bedford, Ohio, and for the further reason that the City wants to replace this equipment at a reduced rate as soon as possible.

WHEREFORE, this Ordinance shall take effect and be in force from and after the earliest date permitted by law.

CITY OF BEDFORD, OHIO

ORDINANCE NO. 029-26



Stanley C. Koci, Mayor – President of Council



Tracy M. Simons, CMC, Clerk of Council

Prepared and approved as to legal content by: \_\_\_\_\_



John J. Montello, Law Director

PASSED: April 6, 2020

FAILED: \_\_\_\_\_

# QUOTE

107858-02-04 • 03/18/2026



A PLAYCORE COMPANY

## City of Bedford - Greencroft Park - 2026 OPRA State Initiative Pricing Rev4.

**Customer:**  
Bedford, City of  
124 Ellenwood Ave  
Bedford, OH 44146-2634  
United States  
Ship to Zip: 44061

**Prepared for:**  
Michael Callahan  
Phone: (440) 735-6570  
mcallahan@bedfordoh.gov

**Prepared by:**  
DWA Recreation  
P.O. Box 208 Harrison, OH 45030  
Toll Free 800-762-7936  
Fax 513-788-1825  
www.dwarec.com  
info@dwarec.com

Quantity	Part #	Description	Unit Price	Amount
1	178749	GameTime - Owner's Kit	\$98.07	\$98.07
1	RDU	GameTime - Gametime Powerscape Play Structure (TBEDFORD_GREENCROFT_2026_REV4)	\$187,967.95	\$187,967.95
1	14927	GameTime - NDS Play On Sign Package		
1	RDU	GameTime - 3.5" Primetime 3 Bay Swing Frame Equipped with the following: (3) Belt Seats (1) Enclosed Tot Seat (1) Expression Swing (1) Zero-G (5-12)	\$9,220.00	\$9,220.00
1	RDU	DWA - Supply & Install (69) 4' x 12" Plastic Play Curbs & (1) Accessible Ramp	\$4,170.00	\$4,170.00
1	RDU	GT-Impax - Supply & Install 233 CY of Engineered Wood Fiber (EWF) Safety Surfacing to 12" Depth	\$9,210.00	\$9,210.00
1	RDU	GameTime - Installation based off the following: DWA Recreation is responsible for the following: - Contact OUPS 811 - Call Before You Dig - Take delivery of equipment prior to installation - Installation of Play Structure - Installation of 3 bay swing frame  <b>Prevaling wage rates</b> Dirt spoils to be left on site  <b>Owner/General Contractor is responsible for the following;</b> - Mark private utilities - Haul away of augured dirt spoils - Site restoration, as needed  Pricing does NOT include permits Pricing does NOT include contractor registration	\$50,510.00 <i>(39 per cy)</i>	\$50,510.00

Contract: OMNIA #2017001134

Sub Total	\$261,176.02
Discount	(\$95,456.02)
Freight	\$4,280.00
<b>Grand Total</b>	<b>\$170,000.00</b>

**Comments**

\*\*\*\*CHECK DUE AT TIME OF ORDER FOR EQUIPMENT AND FREIGHT\*\*\*\*

# QUOTE

107858-02-04 • 03/18/2026



A PLAYCORE COMPANY

The above contract allowance is based on the customer applying for and being awarded funding through the OPRA State Initiative program in partnership with GameTime. Approval and participation in the program is subject to OPRA's final application review, qualification requirements, and available funding. Submission of an application does not guarantee approval or funding.

- **Pricing Basis:** Pricing is based on the customer applying for and being awarded funding through this initiative in partnership with GameTime.
- **Application Deadline:** Applications must be submitted by January 19, 2026 to be considered for this funding cycle.
- **Award Notification:** Applicants may be notified of approval as late as February 6, 2026.
- **Installation Deadline:** All installations must be completed by December 2026 through GameTime's exclusive representatives in Ohio.
- **Funding Conditions:**
  - Funding assistance must be used toward the purchase of a qualified GameTime playground system.
  - To qualify for 100% matching funding assistance, the list price of the qualifying playground system must exceed \$40,000 and be purchased with cash at order.
  - Funding assistance may also be available (up to 50% match) for select outdoor fitness equipment and certain package types.
- **Program Changes:** All dates and program requirements remain subject to change at the discretion of program administrators.
- **No Funding Guarantee:** Submission of an application does not guarantee approval or funding.

Matching funds offer applies to PowerScape® (including Spire®, Altus® and Aventus® Towers), PrimeTime® (including the Odyssey®), Xscape®, and Modern City®, and The Stadium® play systems only. Up to 50% matching funds for select outdoor fitness equipment, including THRIVE®, Challenge Course, and The Stadium®.

See full program terms at [gametime.com/opra](http://gametime.com/opra).

**State Initiative program payments must be made payable to GameTime. Payments made payable to DWA Recreation, Inc. are not eligible for the State Initiative program.**

## Payment terms:

Payment in full, net 30 days subject to credit approval. A 1.5% per month finance charge will be imposed on all past due accounts. Equipment will be invoiced separately from other services and shall be payable in advance of those services and project completion.

**Force Majeure:** No Party to this Agreement shall be responsible for any delays, price increases, or failure to perform any obligation under this Agreement due to acts of God, outbreaks, epidemic/pandemic or the spreading of disease or contagion strikes or other disturbance, including, without limitation, war, insurrection, embargoes, governmental restrictions, acts of governments or governmental authorities, and any other cause beyond the control of such party. During an event of force majeure, the Parties' duty to perform obligations shall be suspended.

# QUOTE

107858-02-04 • 03/18/2026



A PLAYCORE COMPANY

**OMNIA Partners Contract Number: 2017001134**

## To order:

Please complete the acceptance portion of this quotation and provide color selections, purchase order copy and other key information requested.

**This quote does not include any state or local sales taxes. Sales tax will be added to the order if required, unless otherwise noted.**

Acceptance of this proposal indicates your agreement to the terms and conditions stated herein.

## Omnia Partners Purchase Orders must be made out to:

PlayCore Wisconsin Inc. dba GameTime  
c/o DWA Recreation, Inc.  
P.O. Box 208  
Harrison, OH 45030

**Once equipment is ordered, the owner assumes that the equipment is being installed according to the ASTM standards for layout and design. Additionally, the owner shall check to make sure that all appropriate fall zones are current and compliant. In the event that the owner has to return the equipment, both inbound and outbound freight will be charged along with a 25% restocking fee.**

**GameTime Shipping Lead Time:** Current shipping time for GameTime is approximately 6-8 weeks. Please allow an additional 7-10 days for transit.

**Short Ship Claims:** Purchaser has 14 days from receipt of equipment to file a short ship report in writing to our office. Company reserves right to not honor claims made after this time.

**Shipping Time:** Estimated Ship time is 10-12 weeks for certain items on this quote. Please verify current lead time when placing order. Allow 7-10 days for actual transit time.

**Short Ship Claims:** Purchaser has 14 days from receipt of equipment to file a short ship report in writing to our office. Company reserves right to not honor claims made after this time.

## **Exclusions:**

"Unless otherwise indicated in the pricing issued above, this quotation does NOT included the cost(s) or fee(s) associated with (and thusly, DWA Recreation, Inc. & its subcontractors do not anticipate provision of) the following:

- any/all registrations, e.g. Vendor or Contractor Registrations with local City and/or County
- any/all professional licensing, e.g. occupational licensing with local City and/or County
- an/all permitting, e.g. building or zoning permits
- lift-gate service by courier at time of delivery
- acceptance of delivery and offloading by DWA Recreation, Inc., or it subcontractors
- any/all waste management services, e.g. provision of a dumpster
- any/all site restoration, e.g. removal of spoils, rough grading, seeding and/or other reclamation
- any/all inspections

"Unless otherwise indicated, labor rates on installation are NOT figured at Prevailing Wage or Davis-Bacon mandate wage rates. Please contact your DWA Sales Representative if Prevailing Wage/Davis-Bacon rates will apply, or if any of the above mentioned items should be supplied by DWA Recreation, Inc."

We are NOT responsible for building permits and/or any other fees, including hauling away of spoils or reclamation of disturbed areas unless otherwise indicated on quote.

# QUOTE

107858-02-04 • 03/18/2026



A PLAYCORE COMPANY

## Installation Terms:

- The above pricing is based on installation over natural earth and does not include any site work, unless otherwise noted on this quote.
- This pricing does include receiving and storage of the equipment prior to installation.
- Any existing wood chips, asphalt, or playground equipment, in the area where the new structure will be located, must be removed by the owner unless otherwise noted on this quote.
- The play area site would need to be level prior to installation.
- An area will need to be provided for the disposal of excess dirt created when augering holes. Spoils to be left on site unless otherwise noted.
- Access to a dumpster will need to be provided for the disposal of packaging materials and old equipment (if applicable).
- The above pricing is based on non-prevailing wage rates unless otherwise noted.

Please note, you are required by Ohio law to contact "Ohio Utilities Protection Service" at 1-800-362-2764 before any excavation or installation takes place. Because their questions will relate to the location of the site, we ask you to please contact them personally. This should be done within a two week period but not less than four days prior to installation, as they will need 48 hours to mark off the site.

Owner is responsible for verifying and marking all private underground utilities locations prior to installation.

## GameTime Standard Colors

- Accent / Basic / Metal Colors: Yellow, Butterscotch, Orange, Red, Burgundy, Royal Purple, Periwinkle, Blue, Sky Blue, Sea Mist, Azure, Ocean, Spring Green, Chartreuse, Ice Mint, Ice Butter, Sage, Green, Dark Green, Bronze, Brown, Beige, Champagne, Vanilla, White, Metallic, Starlight, Black
- Deck Colors: Blue, Brown, Chocolate, Gray
- Plastic Colors: Yellow, Orange, Red, Green, Chartreuse, Spring Green, Azure, Sky Blue, Blue, Periwinkle, Royal Purple, Burgundy, Brown, Beige, Champagne
- HDPE Colors: Yellow, Orange, Red, Green, Spring Green, Sky Blue, Blue, Purple, Burgundy, Brown, Beige, Dolphin Gray, Black
- 2 Color HDPE: Yellow/Black, Orange/White, Red/White, Green/White, Spring Green/White, Azure/White, Sky Blue/White, Blue/White, Purple/White, Burgundy/White, Brown/White, Beige/Green, White/Black, Gray/Black, Black/White
- Shade Fabric: Sun Blaze, Orange, Yellow, Forest Green, Bottle Green, Lime, Dove Blue, Turquoise, True Blue, Navy Blue, Purple, Royal Purple, Deep Ochre, Brown, Cedar, Latte, Beige, Cream, Silver, Charcoal
- Special Rock: Sandstone, Deep Granite
- Wallcano Handholds: Red, Green, Blue, Beige
- Site Recycled Plastic Lumber: Gray, Tudor, Sand
- VistaRope Standard: Yellow, Sky Blue, Brown, Natural, Black
- VistaRope Custom: Red/Black, Red/Sky Blue, Sky Blue/Yellow, Green/Black

Actual colors may vary from printed or digital representations. Sample materials available upon request. For a visual reference of available color options, please view the GameTime Color Sheet at the following link:

<https://dwarec.box.com/s/1le61tn02ynwhpyr5nnqdlbuwbgl80w7>

You may view Additional Color options and pre-designed play palettes on GameTime's website:

<https://www.gametime.com/resources/color-wizard>

## Acceptance of Colors from 3D Rendering

Please initial here if ordering colors from 3D Rendering: \_\_\_\_\_

# QUOTE

107858-02-04 • 03/18/2026



A PLAYCORE Company

Please indicate desired color palette: \_\_\_\_\_

OR

**Custom Color Selection:**

Metal Uprights (Basic): \_\_\_\_\_

Metal Accents: \_\_\_\_\_

Roto Plastic: \_\_\_\_\_

HDPE: \_\_\_\_\_

2-Color HDPE: \_\_\_\_\_

Decks: \_\_\_\_\_

Rock: \_\_\_\_\_

Rope: \_\_\_\_\_

Shade: \_\_\_\_\_

# QUOTE

107858-02-04 • 03/18/2026



A PLAYCORE COMPANY

## Bill To:

Business/Company: \_\_\_\_\_

Contact: \_\_\_\_\_

Address: \_\_\_\_\_

City, State, Zip: \_\_\_\_\_

Office Phone: \_\_\_\_\_

*(For Accounts Payable)*

Cell Phone: \_\_\_\_\_

Email: \_\_\_\_\_

Fax: \_\_\_\_\_

## Ship To:

Same as Bill To

Business/Company: \_\_\_\_\_

Contact: \_\_\_\_\_

Address: \_\_\_\_\_

City, State, Zip: \_\_\_\_\_

Office Phone: \_\_\_\_\_

Cell Phone: \_\_\_\_\_

*(For Delivery)*

Email: \_\_\_\_\_

Fax: \_\_\_\_\_

## Project/Site Location:

Same as Bill To    Same as Ship To

Business/Company: \_\_\_\_\_

Contact: \_\_\_\_\_

Address: \_\_\_\_\_

City, State, Zip: \_\_\_\_\_

Office Phone: \_\_\_\_\_

Cell Phone: \_\_\_\_\_

Email: \_\_\_\_\_

# QUOTE

107858-02-04 • 03/18/2026



A PLAYCORE COMPANY

Purchasing Information:

Purchase Amount: \$170,000.00

Sales Tax Exemption Certificate #: \_\_\_\_\_

P.O. No: \_\_\_\_\_

Please provide a copy of Tax Exemption Certificate, P.O., Copy of Check, or any other applicable payment information with this quote.

### Acceptance of quotation:

Please Initial:

\_\_\_\_\_ I hereby acknowledge that I have received a copy of this quote and agree to all terms set forth within.

\_\_\_\_\_ I confirm that I have had the opportunity to review and ask questions regarding the terms detailed in this quote. I agree to all terms as stated.

\_\_\_\_\_ I certify that I have carefully read and comprehended the contents of this quote and contract. By signing below, I signify my consent and agreement to all terms specified, including the payment terms.

Accepted By (printed): \_\_\_\_\_ Date: \_\_\_\_\_

Accepted By (signature): \_\_\_\_\_

Title: \_\_\_\_\_

Phone Number: \_\_\_\_\_ Email: \_\_\_\_\_

Quote prepared by: Taylor Kolanko

Sales Representative: Taylor Kolanko - taylork@dwarc.com - 330-206-5453



# Snider Recreation Inc.

10139 Royalton Road, Suite K  
North Royalton, OH 44133

Ph (440)877-9151 Toll Free (800)888-2889 Fx (440)877-9159  
www.cvsnyder.com  
info@cvsnyder.com

# Estimate

Date	Estimate #
2/13/2026	17546R

Name / Address
City of Bedford City Hall Building 165 Center Road Bedford, OH 44146

Project Location
Greencroft Park

Terms	Rep	Customer Phone	Customer Fax	Tax Exempt Number	County
*Due on Receipt*	JS	440-735-6570			Cuyahoga-OH

Item	Description	Qty	Rate	Total
Design	BCI Burke Design 127-212579-2	1	108,000.00	108,000.00
Border 12"	12" Playground Borders	84	45.00	3,780.00
ADAHalfRamp	Half Ramp	2	850.00	1,700.00
Freight	Shipping Charges	1	3,500.00	3,500.00
Installation	Installation of Equipment	1	35,000.00	35,000.00
Surfacing	Engineered Wood Fiber Play Surfacing 300 CY provided and installed via blower truck <i>(50 per cy)</i>	1	15,000.00	15,000.00
	NOTES: Spoils left/distributed onsite			

If tax exempt certificate is not provided appropriate sales tax will be charged.  
Quote valid for 30 days. Credit Card payments will incur an additional 3% fee.

Please be aware that Snider Recreation will never ask you to provide your ACH (bank account and routing number) details through emails or text messages. Any requests should be considered fraudulent. Please call us at 440-877-9151 to confirm any communications you have received.

<b>Subtotal</b>	\$166,980.00
<b>Sales Tax (7.75%)</b>	\$0.00
<b>Total</b>	\$166,980.00

FEIN 46-5631661



1279 Hazelton-Etna Road SW  
 Pataskala, OH 43062  
 614-855-3790  
 www.midstatesrecreation.com

## QUOTATION

<b>Sold To</b>	Greencroft Park 74 Greencroft Rd Bedford, OH, United States	<b>Ship To</b>	Greencroft Park 74 Greencroft Rd Bedford, OH, United States
----------------	--	----------------	--

Date	Quote #	Terms	Rep	Project	Ship Contact
2026-02-06	QTN-19685	Net 10	Adam Grey	2026 01 Greencroft Park - Oh Bedford City Of	
	<b>Valid Until</b> 03-06-2026				

Item Code	Description	Qty	Rate	Amount
Drawing #	Drawing # 26-6953A	1.0 Unit	\$ 0.00	\$ 0.00
350-2077	350-2077	1.0 Unit	\$ 41,610.00	\$ 41,610.00
350-2077	350-2077 Sale Discount	1.0 Unit	\$ -8,322.00	\$ -8,322.00
350-2633	350-2633	1.0 Unit	\$ 31,919.00	\$ 31,919.00
350-2633	350-2633 Sale Discount	1.0 Unit	\$ -11,172.00	\$ -11,172.00
ZZUN7096	LOOPY WHOOP	1.0 Unit	\$ 3,973.00	\$ 3,973.00
ZZUN7140	STATIONARY BUTTONS (12in)	3.0 Unit	\$ 888.00	\$ 2,664.00
ZZUN7146	STATIONARY BUTTONS (18in)	2.0 Unit	\$ 891.00	\$ 1,782.00
ZZXX0148	MOON ROCK	1.0 Unit	\$ 5,216.00	\$ 5,216.00
ZZXX0260	BELT SEAT W/SILVER SHIELD CHAIN FOR 8ft TOP RAIL	4.0 Unit	\$ 187.00	\$ 748.00
ZZXX0265	INFANT SEAT W/SILVER SHIELD FOR 8ft TOP RAIL	1.0 Unit	\$ 324.00	\$ 324.00
ZZXX0409	PUP TENT CLIMBER	1.0 Unit	\$ 6,237.00	\$ 6,237.00
ZZXX0462	SIERRA SUMMIT CLIMBER	1.0 Unit	\$ 8,578.00	\$ 8,578.00
ZZXX0605	4 SEAT SEE-SAW W/ FIXED FULCRUM	1.0 Unit	\$ 4,166.00	\$ 4,166.00
ZZXX0635	SWING ALONG SEAT TO 8ft TOP RAIL	1.0 Unit	\$ 1,371.00	\$ 1,371.00
ZZXX0892	Accessible Swing Seat - 8' top rail	1.0 Unit	\$ 1,680.00	\$ 1,680.00
ZZXX0930	3.5in OD 2-UNIT STEEL ARCH SWING- 8ft TOP RAIL	1.0 Unit	\$ 2,822.00	\$ 2,822.00
ZZXX0932	3.5in OD STEEL ARCH SWING 2-UNIT ADD-A-BAY	2.0 Unit	\$ 1,694.00	\$ 3,388.00
ZZXX0936	3.5in OD STEEL ARCH SWING SINGLE UNITADD-A-BAY	1.0 Unit	\$ 1,589.00	\$ 1,589.00
ZZXX1020	CURVED BALANCE BEAM	1.0 Unit	\$ 916.00	\$ 916.00
ZZXX1361	RIDGE GRIP SPINNER	1.0 Unit	\$ 3,350.00	\$ 3,350.00



1279 Hazelton-Etna Road SW  
 Pataskala, OH 43062  
 614-855-3790  
 www.midstatesrecreation.com

## QUOTATION

Item Code	Description	Qty	Rate	Amount
Discount Playground Supply	Discount Playground Supply (ZZUN and ZZXX Items)	1.0 Unit	\$ -11,387.60	\$ -11,387.60
Freight	Shipping Charges are estimated and are subject to actual shipping charges incurred at time of shipment. Sale Equipment Shipping Charges Free. (\$1,067 Value)	1.0 Unit	\$ 733.33	\$ 733.33
Mulch	251 cy Playground Engineered Wood Fiber Safety Surfacing - ASTM Compliant. Not to exceed 251 cy.	1.0 Unit	\$ 5,595.33	\$ 5,595.33
APS-Border 12"	87 - 12" Playground Border with Spike 1 - ADA Half Ramp System for use with 8" or 12" borders	1.0 Unit	\$ 3,718.67	\$ 3,718.67
Installation Charges	<p><u>Installation Charges Include</u></p> <ul style="list-style-type: none"> <li>• Equipment installation, Includes hauling footer spoils off site.</li> <li>• Border timber/ramp install.</li> <li>• EWF installation.</li> <li>• 30-yard construction Dumpster.</li> </ul> <p><u>Installation Caveats</u></p> <ul style="list-style-type: none"> <li>• Priced assuming all work to take place in 2026.</li> <li>• Assumes easy access to site with equipment materials.</li> <li>• Additional cost will apply for excessive debris found in site.</li> <li>• Customer to remove old equipment, including footers.</li> <li>• Customer to fill old footer holes with compaction gravel.</li> <li>• Assumes level ground existing.</li> <li>• Prevailing wage not figured.</li> <li>• Permits not included</li> <li>• Inspections not included</li> <li>• Customer to locate private utilities</li> <li>• No excavation</li> <li>• No Drainage</li> <li>• No Site restoration</li> </ul>	1.0 Unit	\$ 64,040.00	\$ 64,040.00

<b>Subtotal</b>	\$ 165,538.73
<b>OH - Cuyahoga 8%</b>	\$ 0.00
<b>Total</b>	\$ 165,538.73

### Acceptance of Proposal

(Please be sure you have read, signed, and initialed and understand the terms and conditions) The items, prices, and conditions listed herein are satisfactory and are hereby accepted.



1279 Hazelton-Etna Road SW  
Pataskala, OH 43062  
614-855-3790  
www.midstatesrecreation.com

## QUOTATION

Signature (Approval) \_\_\_\_\_  
 Printed Name \_\_\_\_\_  
 Title \_\_\_\_\_  
 Date \_\_\_\_\_

### TERMS AND CONDITIONS

#### QUOTE CONDITIONS AND ACCEPTANCE:

This quote is only valid for 30 days.

\*\*\* (Pls Initial) It is the Buyer's responsibility to verify quantities and description of items quoted. Once your order has been placed, any changes including additions, deletions, or color changes, could result in price increases, additional fees and could cause delays.

#### **EXCLUSIONS :** Unless specified, this quote excludes all of the following but not limited to:

- Required Permits/Inspections, Background Checks, Davis Bacon, Prevailing Wage or Certified Payroll
- Performance/Payment Bonds
- Site Restoration
- Site work, saw cutting/core drilling, and landscaping.
- Removal of existing equipment
- Unloading; Receiving of inventory or equipment; Storage of equipment.
- Equipment assembly and/or installation
- Safety surfacing; Borders or drainage requirements
- Landscaping Repairs DUE to poor access or in climatic weather

#### **FREIGHT AND DELIVERY: (if applicable)**

Shipping is FOB Origin (means the buyer accepts the title of the goods at the shipment point and assumes all risk once the seller ships the product). All equipment will arrive unassembled.

\*\*\* (Pls Initial) Buyer is responsible to meet and provide adequate personnel/equipment to unload truck. A Check List, detailing all items shipped, will be included with the shipment. Unless taking delivery is specifically included in quote.

Buyer is responsible for ensuring the Sales Order Breakdown and Item Numbers on all boxes and pieces match the Check List.

\*\*\* (Pls Initial) Shortages or damages must be noted on the driver's delivery receipt. Shortages or damages not noted become the buyers financial responsibility.

Please notify Midstates Recreation immediately of any damages.

Shortages and Concealed Damage must be reported to Midstates Recreation within 10 days of delivery.

A reconignment fee will be charged for any changes made to delivery address after order has been placed.

#### **TAXES:**

All orders are subject to applicable sales tax unless a tax exemption form is on file at the time the order is placed.

#### **PAYMENT TERMS:**

An approved Credit Application is required for new customers or customers that haven't been active in the last 18 months. Terms are check with order, or 50% down payment with approved credit (terms do vary based on references). Balance of product & freight will be invoiced upon shipment, due Net 10 days. 100 % prepayment required on



1279 Hazelton-Etna Road SW  
Pataskala, OH 43062  
614-855-3790  
www.midstatesrecreation.com

## QUOTATION

Replacement Parts. A 3% charge will be added to all credit card orders over \$ 3,000.

**For all non-taxpayer-funded entities: A 1.5% monthly service charge will be assessed on all balances over 30 days.**

**RESTOCKING:** Items canceled, returned or refused will be subject to a minimum 25% restocking fee. All return freight charges are the responsibility of the Buyer.

**MAINTENANCE/WARRANTY:**

Manufacturer's standard product warranties apply and cover equipment replacement and freight costs only; labor is not included.

Midstates Recreation offers no additional warranties.

Maintenance of the equipment and safety surfacing is the responsibility of the customer.

Any unauthorized alterations or modifications to the equipment (including layout) will void your warranty.

**Site Preparation & Third-Party Work Disclaimer:**

If excavation, grading, or material placement is performed by a party other than Midstates Recreation, **all work must be coordinated with Midstates Recreation** to ensure alignment with project requirements. We are not responsible for any delays, performance issues, or additional costs resulting from improper compaction, grading, or site preparation by others. Any deficiencies in third-party work that impact our ability to install as specified may require correction at the owner's expense.

**INSTALLATION: (if applicable)**

**Spills are to remain onsite.**

**Permits/inspections are the owner's responsibility and associated costs.**

Customer must locate all underground private utilities before your scheduled installation a third-party private utility service can be provided at an additional cost if necessary. Additional charges may apply if obstruction(s) are encountered beneath the surface. Not responsible for damaged/broken parts on existing playground equipment. Not responsible for crossing sidewalks.

### Acceptance of Terms & Conditions

Acceptance of this proposal, made by an authorized agent of your company, indicates agreement to the above terms and conditions.

Customer Signature

Printed Name and Title

Date

Updated:



This playground has been designed as a project of excellence for inspiring little brothers in youth fitness through fun, swinging, climbing, balancing, and balancing.

Your experience matters. So we here and tell us how you used this space!

# City of Bedford Greencroft Park 2026





**DWA**  
RECREATION  
www.dwarec.com

# City of Bedford Greencroft Park 2026

**GameTime**  
A PLAYCORE COMPANY  
www.gametime.com



# City of Bedford Greencroft Park 2026





**DWA**  
RECREATION  
[www.dwatrec.com](http://www.dwatrec.com)

# City of Bedford Greencroft Park 2026

**GameTime**  
A PLAYCORE company  
[www.gametime.com](http://www.gametime.com)



This is a conceptual rendering of the proposed project. The site shown in rendering is an illustration and may not reflect exact site conditions. It is the property of GameTime PlayCore Company. This site shown in rendering is an illustration and may not reflect exact site conditions.



# City of Bedford Greencroft Park 2026





**GameTime**  
A PLAYCORE company  
[www.gametime.com](http://www.gametime.com)

# City of Bedford Greencroft Park 2026

**DWA**  
RECREATION  
[www.dwarec.com](http://www.dwarec.com)



# City of Bedford Greencroft Park 2026





# City of Bedford Greencroft Park 2026

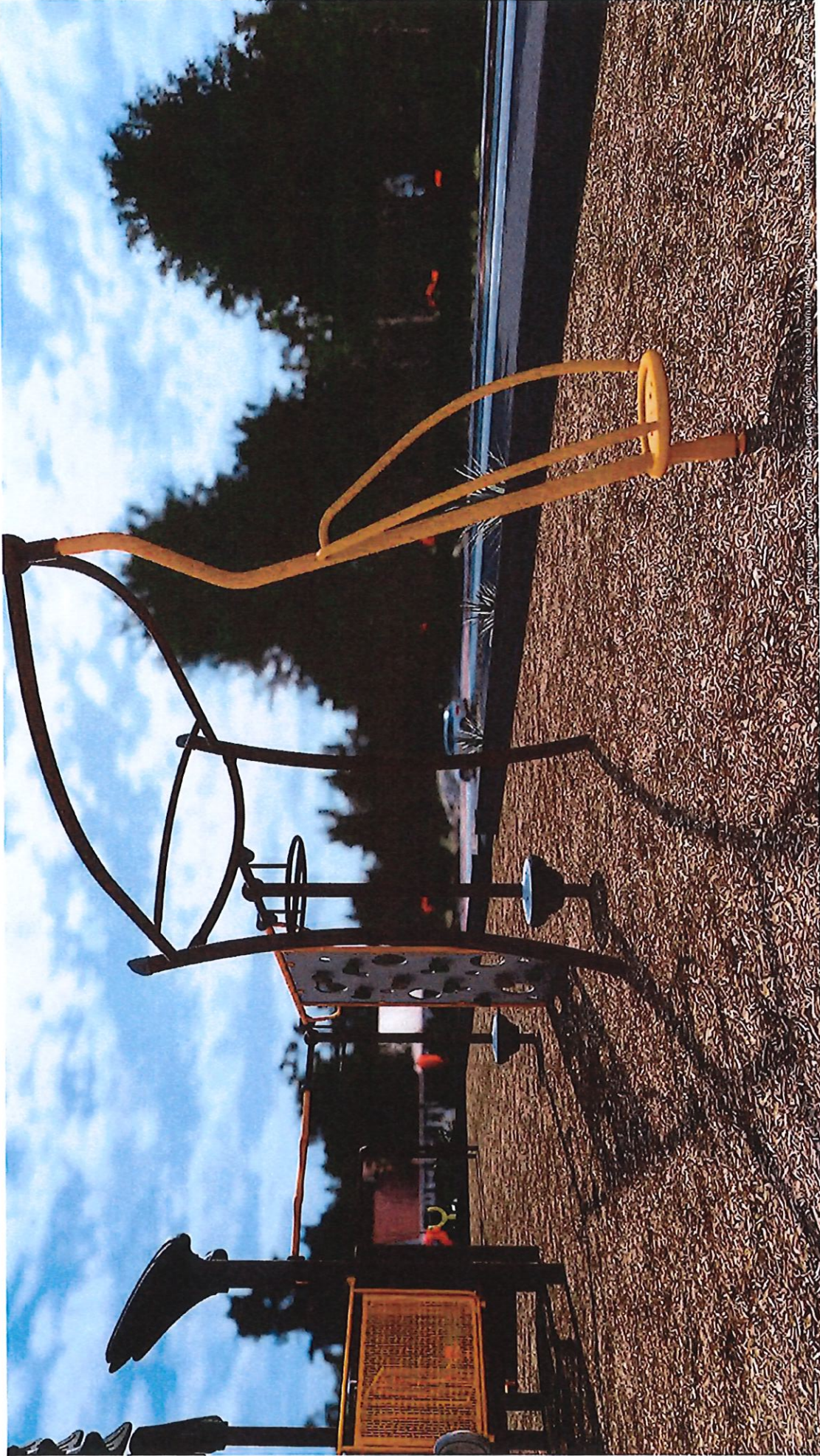

# City of Bedford Greencroft Park 2026





**DWA**  
RECREATION  
[www.dwarec.com](http://www.dwarec.com)

# City of Bedford Greencroft Park 2026

**GameTime**  
A PLAYCORE company  
[www.gametime.com](http://www.gametime.com)



**DWA**  
RECREATION  
www.dwarec.com

# City of Bedford Greencroft Park 2026

**GameTime**  
A PLAYCORE company  
www.gametime.com

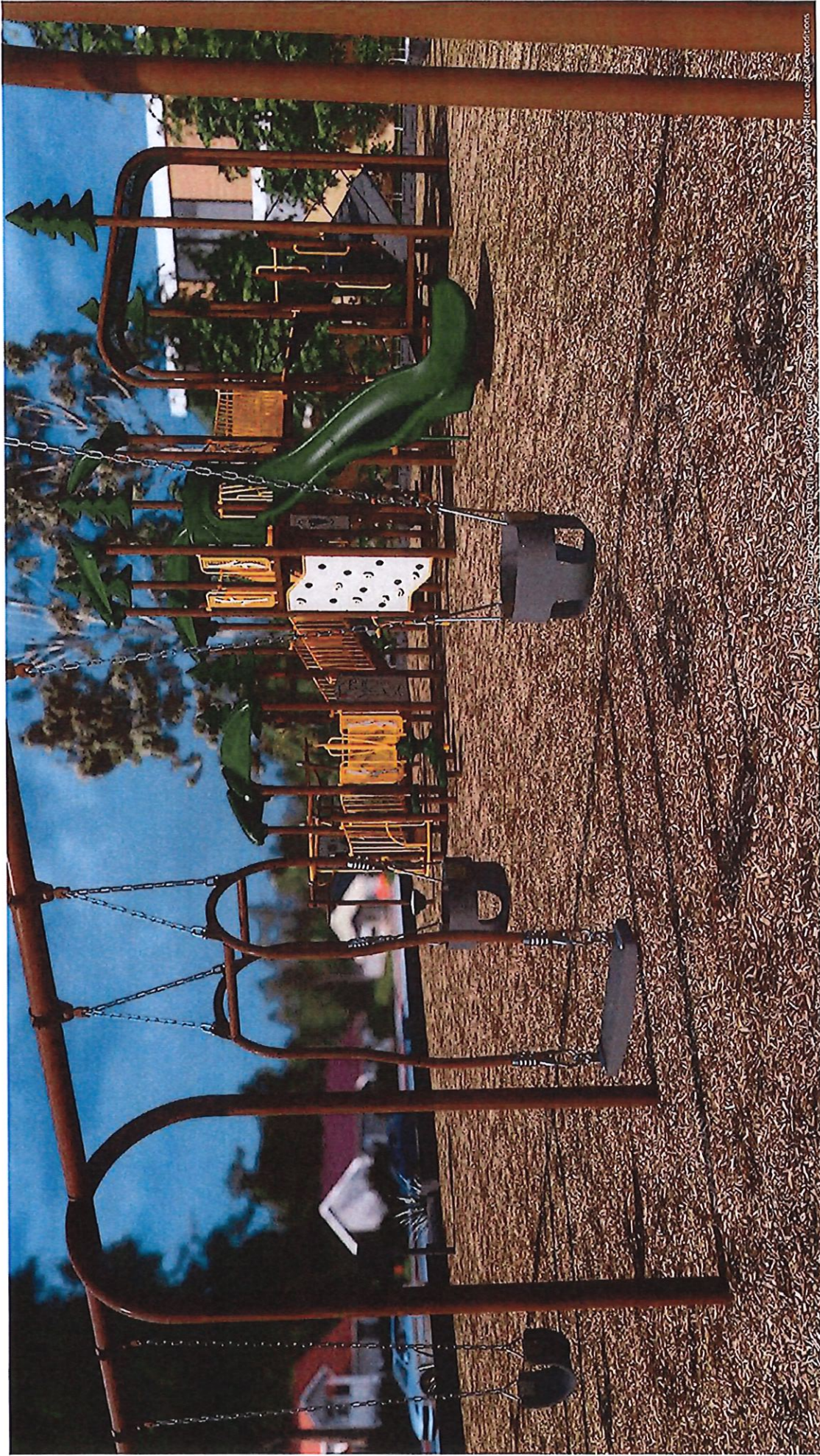

**DWA**  
RECREATION  
www.dwarec.com

# City of Bedford Greencroft Park 2026

**GameTime**  
A PLAYCORE COMPANY  
www.gametime.com



Intellectual property of GameTime, a PlayCore Company. The site shown in rendering is an interpretation and may not reflect exact site conditions.



# City of Bedford Greencroft Park 2026



A PLAYCORE COMPANY  
[www.gametime.com](http://www.gametime.com)

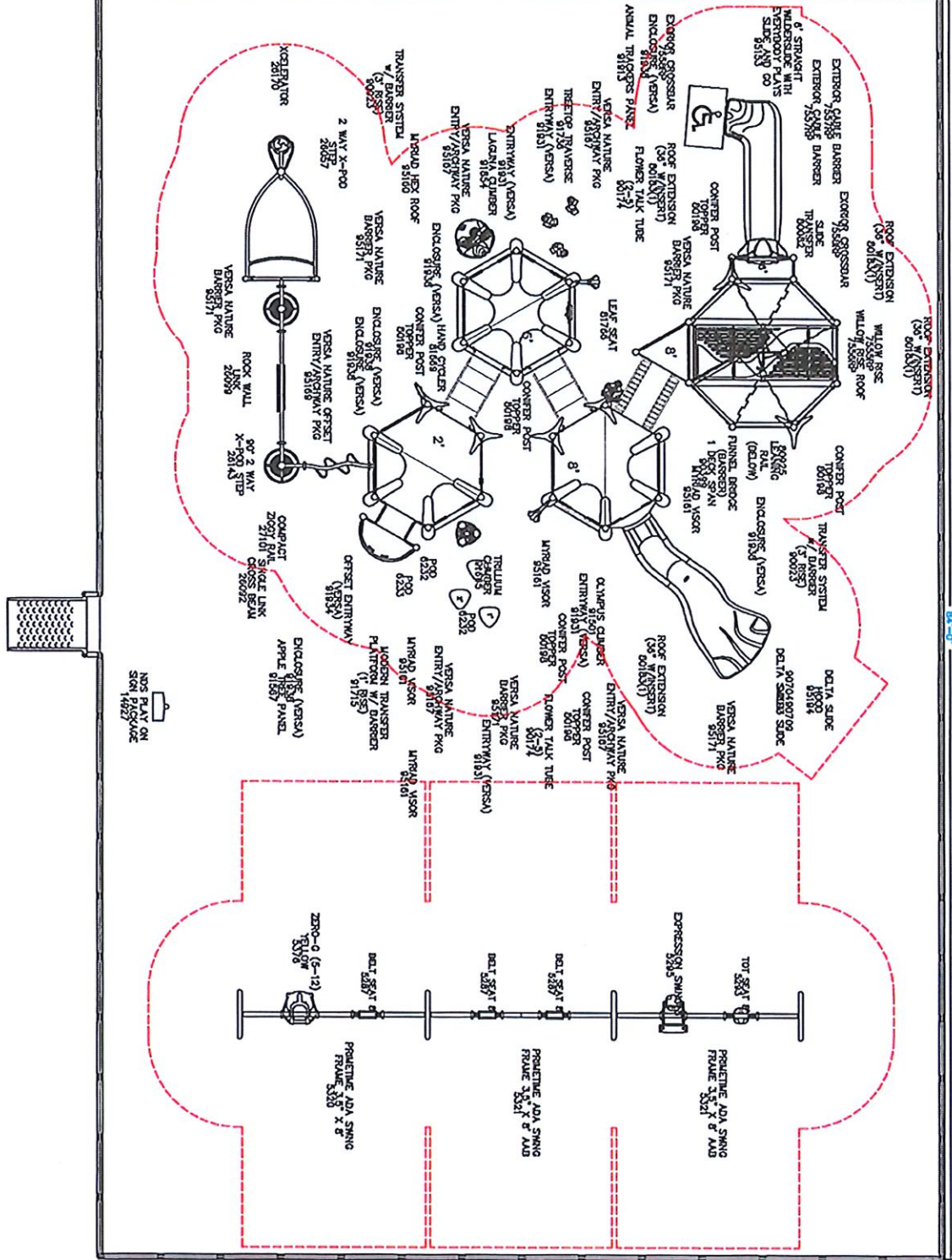

PROJECT TITLE: <b>City of Bedford Greencroft Park Bedford, OH</b>	REPRESENTATIVE: <b>Taylor Kolanko</b>	DRAWING NO.: <b>TBEDFORD_GREENCROFT_2026_REV3</b>	Minimum Area Required: <b>56' x 84'</b>	<b>IMPORTANT:</b> Soft resilient surfacing should be placed in the use zones of all equipment, as specified for each type of equipment, and at depths to meet the critical fall heights as specified by the U.S. consumer Product Safety Commission, ASTM standard F 1487 and Canadian Standard CAN/CSA-Z-614
		DRAWN BY: <b>Taylor Kolanko</b>	DATE: <b>3/17/26</b>	



SHEET NO.:  
**01**